

Dimensional Documentation

viega

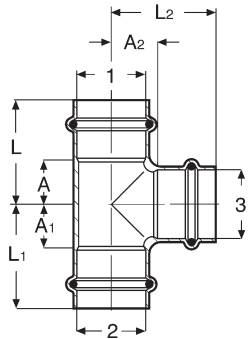

Copper Tee P x P x P - Model 2918 (continued)

Part No.	Size			A (in)	A1 (in)	A2 (in)	L (in)	L1 (in)	L2 (in)
	1	2	3						
79660	1½" x 1" x ¾"			0.67	1.39	1.16	2.17	2.44	2.05
15458	1½" x 1" x 1"			0.74	1.54	1.06	2.17	2.44	1.97
15463	1½" x 1" x 1½"			1.13	1.83	1.13	2.56	2.74	2.56
22233	1½" x 1¼" x ¾"			0.67	1.08	1.15	2.09	2.11	2.05
15453	1½" x 1¼" x 1"			0.74	1.29	1.18	2.17	2.32	2.09
15483	1½" x 1¼" x 1¼"			0.86	1.33	1.13	2.28	2.36	2.17
15448	1½" x 1½" x ½"			0.47	0.47	1.10	1.89	1.89	1.85
77462	1½" x 1½" x ¾"			0.66	0.66	1.14	2.09	2.09	2.05
77467	1½" x 1½" x 1"			0.74	0.74	1.18	2.17	2.17	2.09
77472	1½" x 1½" x 1¼"			0.86	0.86	1.13	2.28	2.28	2.17
77477	2"			1.37	1.37	1.37	2.95	2.95	2.95
15518	2" x 1¼" x 1¼"			0.94	1.84	1.33	2.52	2.87	2.36
15513	2" x 1½" x ¾"			0.70	1.25	1.38	2.28	2.68	2.28
15498	2" x 1½" x 1"			0.82	1.45	1.38	2.40	2.87	2.28
15508	2" x 1½" x 1¼"			0.94	1.55	1.49	2.52	2.97	2.52
15503	2" x 1½" x 1½"			1.13	1.65	1.37	2.72	3.07	2.80
22228	2" x 1½" x 2"			1.38	1.89	1.38	2.95	3.33	2.95
15538	2" x 2" x ½"			0.54	0.54	1.30	2.13	2.13	2.05
94777	2" x 2" x ¾"			0.79	0.79	1.26	2.37	2.37	2.17
94772	2" x 2" x 1"			0.91	0.91	1.30	2.49	2.49	2.21
77487	2" x 2" x 1¼"			1.04	1.04	1.37	2.62	2.62	2.40
77482	2" x 2" x 1½"			1.13	1.13	1.37	2.72	2.72	2.80

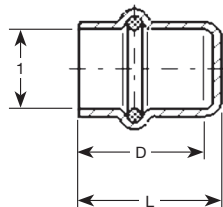

Viega ProPress Cap Copper P - Model 2956

Part No.	Size	L (in)	D (in)
	1		
77712	½"	0.92	0.79
77717	¾"	1.07	0.94
77722	1"	1.11	0.99
77727	1¼"	1.32	1.20
77732	1½"	1.62	1.49
77737	2"	1.69	1.81

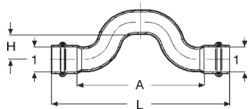

Viega ProPress Cross-Over Copper P x P - Model 2928

Part No.	Size	A (in)	L (in)	H (in)
	1			
77742	½"	3.62	5.12	0.77
77747	¾"	4.49	6.30	0.90

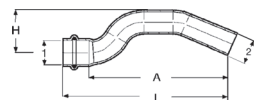

Viega ProPress Cross-Over Copper P x FTG - Model 2927

Part No.	Size		A (in)	L (in)	H (in)
	1	2			
78137	½" x ½"		3.84	4.59	1.20
78142	¾" x ¾"		4.64	5.54	1.54