

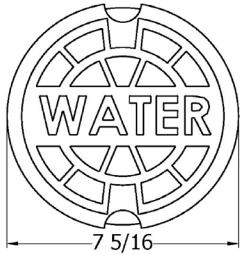

**CAST IRON, SPECIAL  
DROP, AND LOCK LIDS**

**Water Lid**



**Sewer Lid**

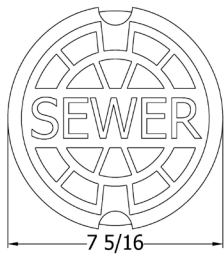

**Gas Lid**



**Reuse Lid**



**Plain Lid**

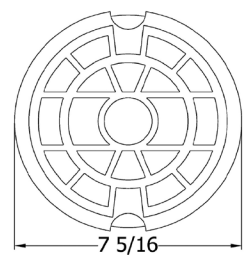

**\*5 1/4 Drop Lid**

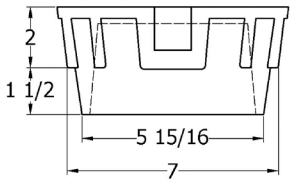

Item/Description	**(D-HD) UPC		**(ND-Std) UPC		Special Mark
	670610	Weight	670610	Weight	
5 1/4 Drop Lid	145325	12	136910	9	WATER
5 1/4 Drop Lid	145349	12	136903	9	SEWER
5 1/4 Drop Lid	145332	12	136873	9	GAS
5 1/4 Drop Lid	458975	12	...	...	REUSE
5 1/4 Drop Lid	145356	12	136897	9	PLAIN

\*\* D=Domestic ND=Non-Domestic HD=Heavy Duty Weight  
Std.=Standard Weight

\*Lids marked WATER will be shipped unless otherwise specified.

**Specialty Lids**

**Lock Lid**

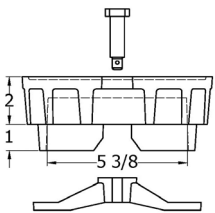
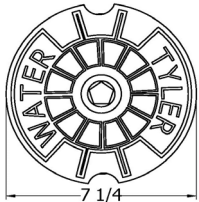

**1 1/8" Lid**

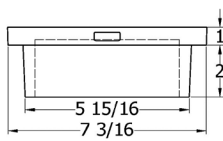
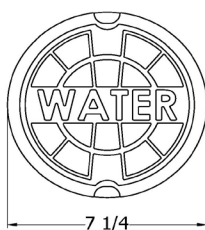

**OMA Lid**

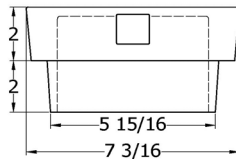
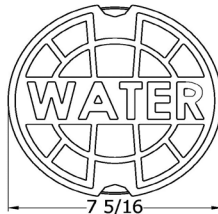

**MWW Lid**

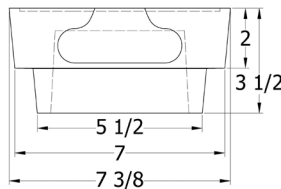

**\*\*\*Square  
Reclaimed Lid**

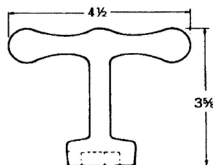
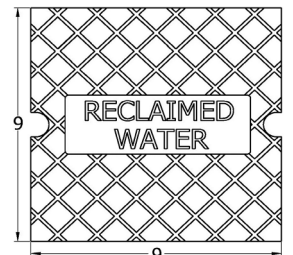

**Wrench**

**Fits Standard Waterworks  
Pentagon Head 27/32" Brass  
Screws**

Item/Description	**(D-HD) UPC		**(ND-Std) UPC		Special Mark
	670610	Weight	670610	Weight	
5 1/4 Lock Lid	145462	11	136866	11	WATER
*1 1/8 Drop Lid	145509	11	112532	9	WATER
5 1/4 OMA Drop Lid	145301	12	136927	12	WATER
5 1/4 MWW Drop Lid	145370	12	136880	12	WATER
***Square Drop Lid	458982	14	...	...	RECLAIMED WATER

\*Note: Use with 1 1/8 Riser only

\*\* D=Domestic ND=Non-Domestic HD=Heavy Duty Weight Std.=Standard Weight

\*\*\*Note: Use with 9T Top #144622

UPCode	Weight	Description
670610		
144908	0.5	Wrench