



630WGD288E

PowerPEX™ Double Stub Out Elbow

- Brazed stub out joint will not fracture

Perfect for running sink and dishwasher supplies (hot side) or sink and ice maker supplies (cold side) off the same branch line.

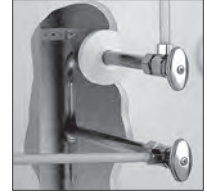

SUPPLY

DRAINAGE

SUPPORT

APPENDIX



Leakproof

Spin closed ends have **five** times the wall thickness of the copper tube. Each fitting is factory inspected.

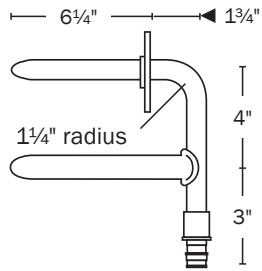

Item No	Connection	CTS	Pkg	Min Qty	Case Qty
630WGD288E	1/2" F1960	1/2"	B	25	25

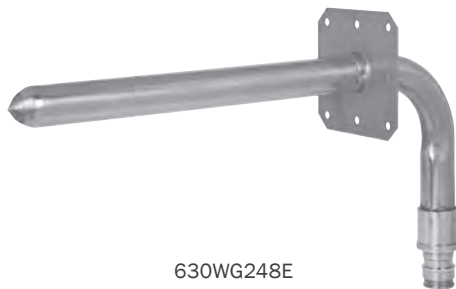

630WG248E

PowerPEX™ Stub Out Elbow

Square O Strap

- Accepts sweat, push-fitting and compression valves
- Combines easy adapting of copper stub outs with easy installation of F1960 PEX system
- Square O Straps affix easily to the Edge bracket or any backing board to provide solid installations
- Multiple mounting holes allow for installations on sides, bottom, or top



Leakproof

Spin closed ends have **five** times the wall thickness of the copper tube. Each fitting is factory inspected.

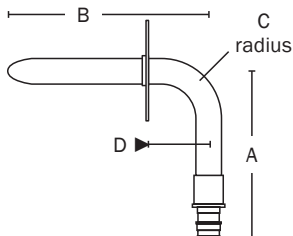

Item No	Connection	CTS	Dimensions				Pkg	Min Qty	Case Qty
			A	B	C	D			
630WG248E	1/2" F1960	1/2"	4"	8"	1 1/4"	1 3/4"	B	25	25
630WG348E	3/4" F1960	3/4"	6"	8"	1 3/4"	1 3/4"	B	25	25
630WG4612E	1" F1960	1"	6"	12"	2"	2"	B	10	10