

Core & Coil (71A) MH 175W - 450W

CORE & COIL HID 71A5750001D

The basic ballast is the open core and coil which is most often used as a component within a lighting luminaire. The core and coil also forms the nucleus of Philips Advance's five other ballast configurations.

Product data

General Information	
ANSI Code	M58
Lamp Type	250W MH
Number Of Lamps	1 piece/unit
Circuit Type	CWA
Ballast Type	Magnetic HID
Base Model	71A5750
Core Size	4 1/4 x 4 3/4 (2 coil)
Suitable For Outdoor Use	Yes
Ignitor Catalog Number	NA
Ignitor Temperature Rating	NA
Capacitor Value	15 MFD
Capacitor Catalog Number	7C150P40R
Capacitor Requirements	400V
Capacitor Temperature Rating	105°C
Capacitor Diameter/Oval Dimensions	1.75 in
Capacitor Height	3.75 in
Automatic Restart	No

Operating and Electrical	
Input Voltage	120/208/240/277/480 V
Input Frequency	60 Hz
Input Current (Open Circuit)	2/1.2/1/0.9/0.5 A
Input Current (Starting)	2.4/1.4/1.2/1.05/0.6 A
Input Current (Short Circuit)	1.9-2.9/1.1-1.7/0.9-1.4/0.8-1.25/0.45-0.75 A
Secondary Short Circuit Current	2.25-2.8 A
Constant Wattage Deviation	10%
Ballast Factor (Nom)	1
Power Factor (Nom)	0.90
Open Circuit Voltage	315 V
Input Current (Nom)	2.6/1.5/1.4/1.1/0.65 A A
Input Power (Nom)	290 W
Rated Lamp Power	250 W

Wiring	
Wire Striplength	0.5 mm
Wire Length By Color	12"
Wire Type	Stranded
Remote Wiring Configuration Allowed	Yes

Core & Coil (71A) MH 175W - 450W

Max Ballast-Lamp Distance Remote Wiring	Determined by AWG used
Recommended Fuse Value	8/5/5/3/2 A
Approval and Application	
Open Circuit Voltage Test (Volts)	285-345 V
Approval Marks	ULR CSA certificate RoHS Compliant
Temperature Marking	A/A/B/A/B
UL Recognized	Yes
Hipot Test (1 Minute)	2000 V
Hipot Test (2 Seconds)	2500 V
UL Insulation Class	H(180°C)
UL Temperature Code	1029B

Product Data	
Order product name	CORE & COIL HID 71A5750001D
EAN/UPC - Product	781087111789
Order code	913710413801
Numerator - Quantity Per Pack	1
Numerator - Packs per outer box	1
Material Nr. (12NC)	913710413801
Net Weight (Piece)	0.010 kg

Dimensional drawing

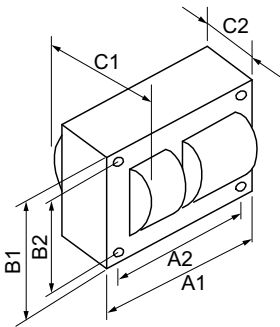

MH BAL 250W M58 5-TAP KIT

Product	C1	C2	A1	A2	B1	B2
CORE & COIL HID 71A5750001D	3.1 in	1.6 in	4.8 in	4.4 in	4.3 in	3.9 in

