



**Dearborn®
Brass**

4675 W. 160th St.
Cleveland, Ohio 44135
Ph: (800) 321-9532
Fax: (800) 321-9535
www.dearbornbrass.com

SUBMITTAL SPECIFICATION

**BRASS TUBULAR
1-½" REPAIR TRAPS**

Engineering Specification: Dearborn Brass 1-½" Brass Tubular Repair Traps are designed for use in tubular drain applications.

Job Reference

DESCRIPTION

- Chrome Finish
- 20 Gauge Brass
- Repair Trap
 - J-Bend
 - Repair Outlet Bend with Brass Nut
 - (3) Rubber Washers
 - (2) Zinc Nuts

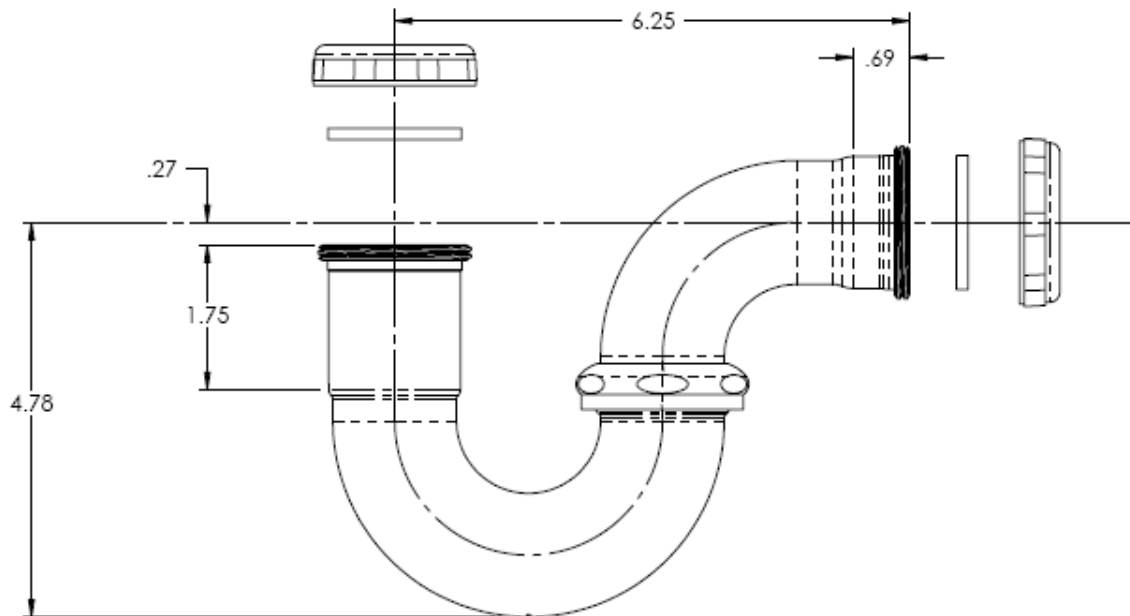
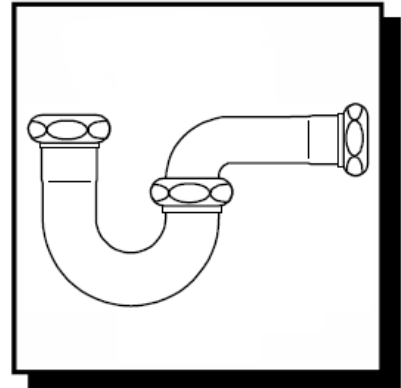

✓	Product No.	Description	Carton Quantity	Carton Weight (lbs)
	702R-1	1-½" Repair Trap – 20 Gauge	10	10

Data is subject to manufacturing tolerances.