

FLUSH VALVE DIAPHRAGM KITS

AquaVantage®

Flush Valve	Flow Rate (gpf)
P6000-ECA-FF	4.5 gpf
P6000-ECA-WS	3.5 gpf
P6000-ECA-TRN	2.7 gpf
P6000-ECA-PWS	2.4 gpf
P6000-ECA-WS1	1.6 gpf
P6000-ECA-HET	1.28 gpf

Flush Valve - Rebuild Kits

P6000-ECA-FF-RK	4.5 gpf
P6000-ECA-WS-RK	3.5 gpf
P6000-ECA-TRN-RK	2.7 gpf
P6000-ECA-PWS-RK	2.4 gpf
P6000-ECA-WS1-RK	1.6 gpf
P6000-ECA-HET-RK	1.28 gpf

Urinal - Repair Kits

P6000-EUA-FF	3.0 gpf
P6000-EUA-WS	1.5 gpf
P6000-EUA-WS1	1.0 gpf
P6000-EUA-EWS	0.5 gpf
P6000-EUA-ULF	0.125 gpf

Urinal - Rebuild Kits

P6000-EUA-FF-RK	3.0 gpf
P6000-EUA-WS-RK	1.5 gpf
P6000-EUA-WS1-RK	1.0 gpf
P6000-EUA-EWS-RK	0.5 gpf
P6000-EUA-ULF-RK	0.125 gpf

Aquaflush®

Flush Valve	Flow Rate (gpf)
P6017-ECR	6.5 gpf
P6000-ECR-FF	4.5 gpf
P6000-ECR-WS	3.5 gpf
P6000-ECR-TRN	2.7 gpf
P6000-ECR-PWS	2.4 gpf
P6000-ECR-WS1	1.6 gpf

Flush Valve - Rebuild Kits

P6017-ECR-RK	6.5 gpf
P6000-ECR-FF-RK	4.5 gpf
P6000-ECR-WS-RK	3.5 gpf
P6000-ECR-TRN-RK	2.7 gpf
P6000-ECR-PWS-RK	2.4 gpf
P6000-ECR-WS1-RK	1.6 gpf

Urinal - Repair Kits

P6000-EUR-FF	3.0 gpf
P6000-EUR-WS	1.5 gpf
P6000-EUR-WS1	1.0 gpf
P6000-EUR-EWS	0.5 gpf

Urinal - Rebuild Kits

P6000-EUR-FF-RK	3.0 gpf
P6000-EUR-WS-RK	1.5 gpf
P6000-EUR-WS1-RK	1.0 gpf
P6000-EUR-EWS-RK	0.5 gpf

Note: -RK Kits include: Repair Kit, Vacuum Breaker, Tailpiece O-Ring, and Handle Repair Kit.

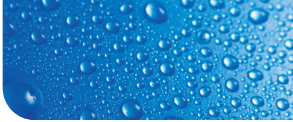

WHY USE ZURN "GO BLUE" PARTS?

Superior chemical resistance equates to 8-10 times longer life than traditional black rubber components.

- Chemical and Clog Resistant Diaphragm
- Diaphragm Disc
- No Leak Handle O-Ring
- Handle Seal / Handle Washer
- Tailpiece O-Ring
- Stop Valve Seal / Stop Valve O-Ring
- Vacuum Breaker
- Spud Gasket / Spud Washer

BEFORE TESTING

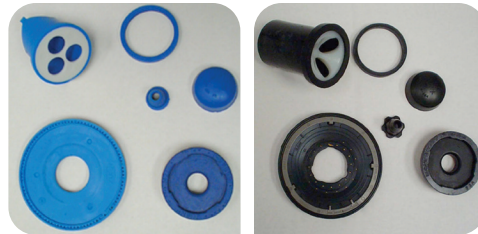

Zurn TPE

Permex®

AFTER TESTING



Zurn TPE

Permex®

QUALITY · DEPENDABILITY · LONG LASTING

Zurn's "Go Blue" material is used in all Zurn flush valves and parts. The chemical resistant gaskets and seals of the Zurn AquaVantage® and Aquaflush® flush valves offer long lasting quality and dependability.

FLUSH VALVE CROSS REFERENCE

Zurn Part Number	Sloan® Part Number	Zurn Part Number	Sloan® Part Number
------------------	--------------------	------------------	--------------------

Diaphragm Kits

P6000-ECA-WS	A-1038-A
P6000-EUA-WS	A-1037-A
P6000-ECA-WS1	A-1041-A
P6000-EUA-WS1	A-1042-A
P6000-EUA-EWS	A-1043-A
P6000-ECA-PWS	A-1044-A
P6000-ECA-HET	A-1045-A
P6000-ECA-WS1-RK	A-1101-A
P6000-ECA-WS-RK	A-1102-A
P6000-ECA-PWS-RK	A-1103-A
P6000-EUA-EWS-RK	A-1106-A
P6000-EUA-WS1-RK	A-1107-A
P6000-EUA-WS-RK	A-1108-A
P6000-ECR-FF	A-36-A
P6000-EUR-WS	A-37-A
P6000-ECR-WS	A-38-A
P6000-ECR-WS1	A-41-A
P6000-EUR-WS1	A-42-A
P6000-EUR-EWS	A-43-A
P6000-ECR-PWS	A-44-A
P6000-ECR-FF-RK	R-1001-A
P6000-EUR-WS-RK	R-1002-A
P6000-ECR-WS-RK	R-1003-A
P6000-ECR-WS1-RK	R-1004-A
P6000-EUR-WS1-RK	R-1005-A
P6000-EUR-EWS-RK	R-1011-A
P6000-ECR-PWS-RK	R-1012-A

Handles & Handle Parts

P6000-M-ADA	A-31
P6000-M-ADA-DF	WES-212-A
P6000-MK	B-39-A
P6000-M10	B-50-A
P6000-M9	B-73-A

Stop Parts

P6000-D-SD	H-541-A
P6003-D-SD	H-543-A
P6000-VC	H-573-A
P6000-C-SD-CP	H-700-A
P6003-C-SD-CP	H-700-A
P6000-YBYC	H-633-AA
P6003-YBYC	H-636-AA

Spud Component Parts

P6000-H	F-5-A
P6003-H	F-5-A
P6001-H	F-5-A
P6000-H25-CP	F-20-A
P6003-H25-CP	F-20-A
P6001-H25-CP	F-20-A
P6000-H26	F-3
P6003-H26	F-3
P6001-H26	F-3
P6000-H27	F-5
P6003-H27	F-5
P6001-H27	F-5
P6000-H28	F-7
P6003-H28	F-7
P6001-H28	F-7

Tailpieces & Tailpiece Parts

P6000-J2	H-551-A
P6000-J3	H-551-A
P6000-J4	H-551-A
P6000-C31	H-553
P6000-C30	H-552

Replacement Caps

P6000-L	A-71
P6000-LLS	A-72

Vacuum Breaker Parts

P6000-A-CP	V-500-AA
P6003-A-CP	V-500-AA
P6001-A-CP	V-500-AA
P6000-A-AA-CP	V-600-AA
P6003-A-AA-CP	V-600-AA
P6001-A-AA-CP	V-600-AA
P6000-B	V-551-A
P6000-B-HP	V-651-A

Sensor Product

ZERK-CPM	EBV-89A-M
ZERK-CP	EBV-89A-P



Flush Valve Parts



Zurn Industries, LLC
Commercial Brass Operation
5900 Elwin Buchanan Drive
Sanford, NC U.S.A.
T 800-997-3876
F 919-775-3541
www.zurn.com
Form No. ZMKTG240-05, Rev. 6/12

Sustainability and performance ...
AquaVantage®.
 The best performing flush valve diaphragm.

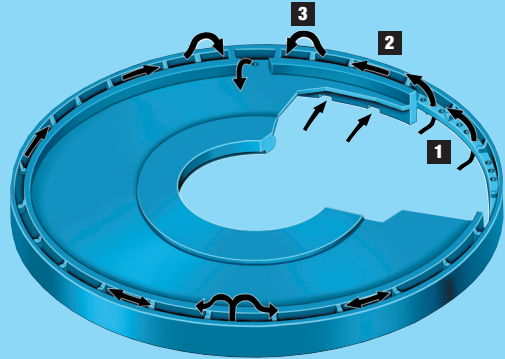

HOW THE ZURN DIAPHRAGM WORKS

- 1 Water from the lower valve chamber is directed through a plurality of individual passageways and into one of the twenty-two filter cells found around the perimeter of the diaphragm. Each filter cell stops unwanted debris and allows only clean water to proceed toward the main orifice.
- 2 The filtered water then travels over a number of parabolic weirs. Each weir acts as a small dam causing the finest of sediment to settle from the water flow.
- 3 The filtered water is then filtered one more time through another set of filter holes strategically placed adjacent to the main orifice. Only clean, filtered water is passed through the main by-pass orifice.

FLUSH VALVE REPLACEMENT PARTS



P6000-B
 High Pressure Vacuum Breaker Kit



P6000-ECA-WS1
 AquaVantage Repair Kit



P6000-D-SD
 1" Screwdriver Stop Repair Kit



P6000-ECR-WS1
 Aquaflush Repair Kit



P6000-MK
 Handle Repair Kit



P6000-L
 Inner Plastic Cap



P6000-M-ADA
 Replacement Handle



P6000-C31
 Tailpiece O-ring

WHY USE ZURN SENSOR PRODUCTS?

- Increased Sanitation
- User Friendly
- Water Savings
- Hands-Free Operation
- Eliminates Odors and Unflushed Fixtures
- Reduced Flush Valve Maintenance
- Improves Building Presentation
- Modern Appearance



ZERK-CCP E-Z Flush Sensor

The Zurn AquaSense® E-Z Flush® Sensor is the most installer-friendly flush valve retrofit kit on the market today. Not only does E-Z Flush provide you the fastest and easiest changeover, but E-Z Flush gives you the tools, batteries and adaptors to start and complete the job. Once installed, E-Z Flush provides trouble-free automatic flushing for both the building owner and the user.

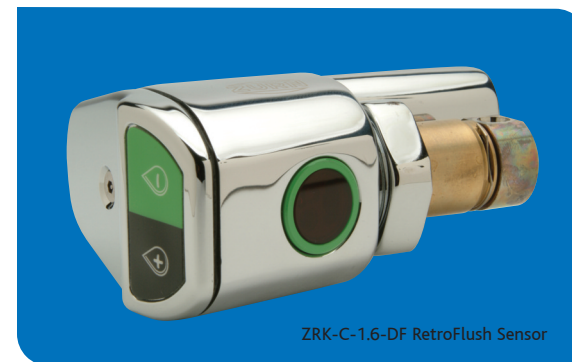

ZRK-C-1.6-DF RetroFlush Sensor

The Zurn RetroFlush® Dual Flush uses the latest sensor technology to offer unparalleled performance while saving you money and water. The Dual Flush model features two flush cycles. A reduced flush that saves 30% water and a standard full flush make Dual Flush an excellent choice for owners looking to reduce building cost and water usage.

FLUSH VALVE REPAIR PARTS

Stop Parts

P6000-D-SD	1" Repair Kit
P6003-D-SD	3/4" Stop Valve Repair Kit
P6000-VC	Control Stop Cover
P6000-C-SD-CP	1" Chrome-Plated Stop
P6003-C-SD-CP	3/4" Chrome-Plated Stop

Wheel Handle Stop

P6000-D-WH	1" and 3/4" Repair Kit
------------	------------------------

Wall Flange & Sweat Solder Kit

P6000-YBYC	1" Wall Flange and Sweat Solder Kit
P6003-YBYC	3/4" Wall Flange and Sweat Solder Kit

Vacuum Breaker Parts

P6000-A-CP	1-1/2" x 9" Vacuum Breaker less Nut
P6003-A-CP	3/4" x 9" Vacuum Breaker less Nut
P6001-A-CP	1-1/4" x 9" Vacuum Breaker less Nut
P6000-A-AA-CP	1-1/2" x 9" Vacuum Breaker with Nut
P6003-A-AA-CP	3/4" x 9" Vacuum Breaker with Nut
P6001-A-AA-CP	1-1/4" x 9" Vacuum Breaker with Nut
P6000-AA-CP	Vacuum Breaker Tube Nut
P6000-B	Vacuum Breaker Repair Kit
P6000-B-HP	High Pressure Vacuum Breaker Repair Kit

Replacement Caps

P6000-L	Inside Plastic Cover
P6000-LL-CP	Outside Brass Cover
P6000-LLS	Replacement Cap for Sloan® Royal and Regal
P6000-19	Valve Replacement Body

Handle & Handle Parts

P6000-M-ADA	ADA Compliant Handle Assembly
P6000-M-ADA-BG	ADA Compliant Handle Assembly with BioCare Anitmicrobial Coating
P6000-M-ADA-DF	ADA Compliant Dual Flush Handle Assembly
P6000-M-ADA-BG-DF	ADA Compliant Dual Flush Handle Assembly with BioCare Anitmicrobial Coating

P6000-MK	Handle Repair Kit
P6000-M9	Handle Cone Seal
P6000-M10	Handle Gasket

Tailpieces & Tailpiece Parts

P6000-J2	3-1/16" Tailpiece
P6000-J3	4-1/16" Tailpiece
P6000-J4	5-1/16" Tailpiece
P6000-C31	Tailpiece O-Ring
P6000-C30	Tailpiece Snap/Lock Ring

Spud Component Parts

P6000-H	1-1/2" Spud Escutcheon and Coupling Assembly
P6003-H	3/4" Spud Escutcheon and Coupling Assembly
P6001-H	1-1/4" Spud Escutcheon and Coupling Assembly
P6000-H25-CP	1-1/2" Spud Nut
P6003-H25-CP	3/4" Spud Nut
P6001-H25-CP	1-1/4" Spud Nut
P6000-H26	1-1/2" Spud Fiber Washer
P6003-H26	3/4" Spud Fiber Washer
P6001-H26	1-1/4" Spud Fiber Washer
P6000-H27	1-1/2" Spud Rubber Gasket
P6003-H27	3/4" Spud Rubber Gasket
P6001-H27	1-1/4" Spud Rubber Gasket
P6000-H28	1-1/2" Spud Escutcheon
P6003-H28	3/4" Spud Escutcheon
P6001-H28	1-1/4" Spud Escutcheon

EZ-Flush Sensor Units

ZERK-CPM	EZ Flush Chrome-Plated Metal
ZERK-CP	EZ Flush Chrome-Plated Plastic
ZERK-CCP	EZ Flush Chrome-Plated Impact Resistant

RetroFlush Sensor Units

ZRK-C-1.6-DF	1.6 GPF Dual Flush Sensor Retrofit Kit
--------------	--

Thank you for purchasing Zurn parts.
 Please return to the counter when you are finished.