

EP Valved Manifold ProPEX® Inlet

Submittal Information
Revision B: Feb. 3, 2016

Project Information

Job Name:

Location:

Part No. Ordered:

Engineer:

Date Submitted:

Contractor:

Submitted By:

Manufacturer's Representative:

Approved By:

Technical Data

Material: Polyphenylsulfone

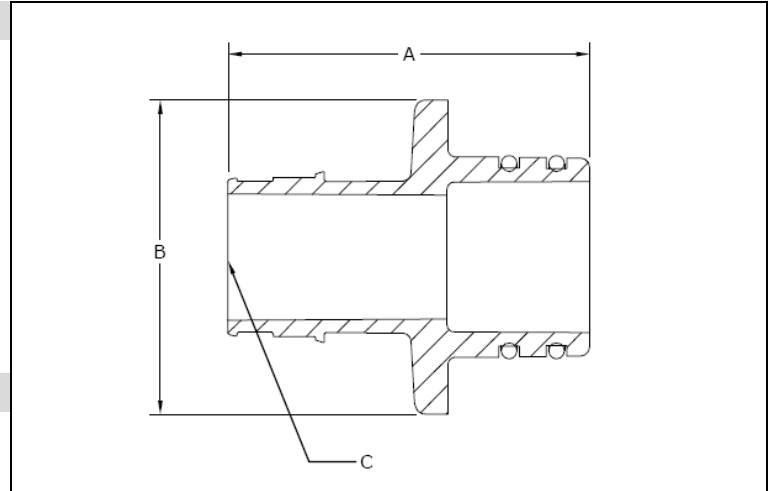

Product Information and Application Use

EP Valved Manifold ProPEX® Inlet connects 3/4" and 1" Uponor AquaPEX® tubing to the manifold.¹

✓ Description	Part Number	A	B	C	Weight
EP Valved Manifold 3/4" ProPEX Inlet	Q2120750	2.13"	2.04"	3/4" ProPEX	0.70 lbs.
EP Valved Manifold 1" ProPEX Inlet	Q2121000	2.13"	2.04"	1" ProPEX	0.80 lbs.

Installation

Do not use thread sealant on connections. Carriers present in these compounds can crack the plastic port connections, resulting in leaks and water damage. Any bend within 6 inches of the ProPEX connection to the manifold requires the use of a Tube Talon or Bend Support. Refer to the Uponor Professional Plumbing Installation Guide for further instructions.

Standards

CAN/CSA B137.5; ASTM F877; ASTM F1960

Codes

IPC; UPC; NSPC; NPC of Canada

Listings

IAPMO 3558; HUD MR 1269; ICC ESR 1099; ANSI/NSF 14- and 61-certified

Related Applications

PEX-a Plumbing Systems

Contact Information

Uponor, Inc.
5925 148th Street West
Apple Valley, MN 55124 USA
Phone: (800) 321-4739
Fax: (952) 891-2008
www.uponorpro.com

Uponor Ltd.
2000 Argentia Road, Plaza 1, Suite 200
Mississauga, ON L5N 1W1 CANADA
Phone: (888) 994-7726
Fax: (800) 638-9517
www.uponorpro.com

¹ProPEX® is a registered trademark of Uponor, Inc. ProPEX™ is a trademark of Uponor Ltd.