

# SHALLOW ESCUTCHEON

920/921 SERIES

TrimTite™

ITEM # SUBMITTED	_____
JOB NAME	_____
LOCATION	_____
ENGINEER	_____
CONTRACTOR	_____
PO#	_____ TAG _____

## SPECIFICATION

Sioux Chief 920-921 Series TrimTite shallow escutcheon shall be used where necessary on copper or steel stub outs. Escutcheons shall be 100% corrosion proof. Escutcheon shall be molded out of a “shape-memory” material which will retain its shape and grip on tube permanently. Escutcheon shall be designed to work with either CTS or IPS tubing and be available in white.

## MATERIAL

Polyethylene

## DIMENSIONS

920 Series	3/8"	1/2"	3/4"	1"	1 1/2"	2"
A: outer diameter	2 1/2"	2 1/2"	2 1/2"	2 1/2"	—	—
B: inner diameter	3/8" CTS	1/2" CTS	3/4" CTS	1" CTS	—	—
C: thickness	9/16"	9/16"	9/16"	9/16"	—	—

921 Series	3/8"	1/2"	3/4"	1"	1 1/2"	2"
A: outer diameter	—	2 1/2"	2 1/2"	3 1/2"	3 1/2"	3 1/2"
B: inner diameter	—	1/2" IPS	3/4" IPS	1" IPS	1 1/2" IPS	2" IPS
C: thickness	—	9/16"	9/16"	9/16"	9/16"	9/16"



920-2W

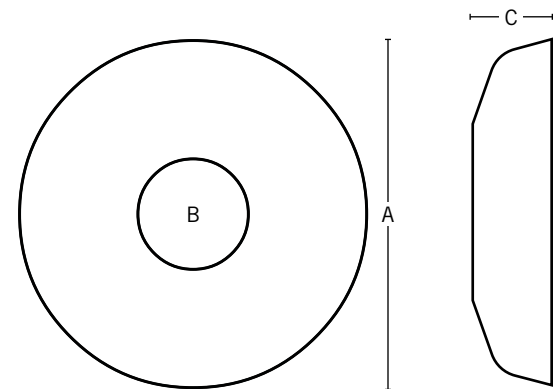

Made In USA

## Create Item Number

### A-BW

e.g. **920-2W**: white escutcheon for 1/2" CTS tube

#### TUBING TYPE A

**920** = for CTS tube

**921** = for IPS tube

\*CTS only

†IPS only

#### TUBING SIZE B

**1** = 3/8"\*

**2** = 1/2"

**3** = 3/4"

**4** = 1"

**6** = 1 1/2"†

**7** = 2"†