

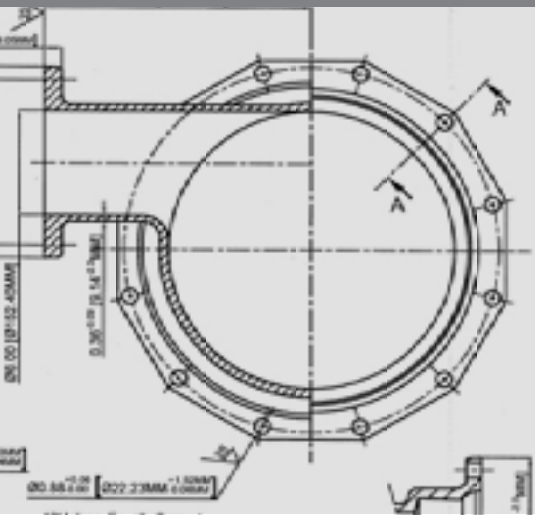

Quality – Service – Commitment – Delivered.

C153 DUCTILE IRON MECHANICAL JOINT FITTINGS



C153 DUCTILE IRON MECHANICAL JOINT FITTINGS BASIC SPECIFICATIONS

- SIZES:**
- 2" - 64"
- MATERIAL:**
- Ductile Iron ASTM A536, Grade 65-45-12, 60-42-10 or 70-50-05.
- PRESSURE:**
- 350 PSI Water Working Pressure 2" - 24".
 - 250 PSI Water Working Pressure 30" - 48".
 - 150 PSI Water Working Pressure 54" - 64".
- TESTING:**
- In accordance with ANSI/AWWA C153/A21.53.
 - In accordance with UL - FM requirements.
 - All fittings are hydrostatically tested in accordance with SIGMA Quality Management Standard.
 - All fittings are heat coded to ensure traceability and verification of metallurgical properties in accordance with the prevailing standards and SIGMA Quality Management Standards.
- LAYING LENGTH:**
- Short body design - straight section of body deleted to provide a compact and lighter fitting without reducing strength or flow characteristics.
- DEFLECTION:**
- In accordance with ANSI/AWWA C153/A21.53.
 - Maximum allowable deflection for MJ Joint on a full length pipe is as mentioned below:
 1. 3" - 4" = 8 Degrees
 2. 6" = 7 Degrees
 3. 8" - 12" = 5 Degrees
 4. 14" - 48" = 3 Degrees
- CEMENT LINING:**
- Double cement lined in accordance with ANSI/AWWA C104 / A21.4.
- COATING:**
- Interior of fitting is seal coated (asphaltic material) in accordance with ANSI AWWA C104/A21.4 and NSF61 approved.
 - Exterior of fitting is seal coated (asphaltic material) in accordance with ANSI/AWWA C153/A21.53 and NSF approved.
- GASKETS:**
- SBR in accordance with ANSI/AWWA C111/A21.11.
 - Also available in EPDM, NBR and CR.
- T-BOLTS:**
- Low Alloy corrosion resistant high strength steel in accordance with ANSI/AWWA C111/A21.11.
- APPROVALS:**
- 3"-16" Underwriters Laboratories listed and Factory Mutual Approved.
- STANDARDS:**
- Certified to NSF61 Standard including Annex G & 372.
 - ANSI/AWWA C153/A21.53 for Compact Ductile Iron Fittings 2"-64" for water and other liquids.
- INSTALLATION:**
- Per ANSI/AWWA C600 and C111 using DIP conforming to C150/C151 and PVC pipe conforming to C900/C905.

C153 DUCTILE IRON MECHANICAL JOINT FITTINGS



Quality – Service – Commitment – Delivered.

Crosses (continued)

| Size | | Item No. | H | J | T | T1 | Wt. |
|------|--------|----------|-------|-------|------|------|------|
| Run | Branch | | | | | | |
| 30 | 20 | DMC3020 | 15.00 | 20.00 | 0.66 | 0.57 | 991 |
| 30 | 24 | DMC3024 | 16.00 | 20.00 | 0.66 | 0.61 | 1246 |
| 30 | 30 | DMC3030 | 22.00 | 22.00 | 0.66 | 0.66 | 1840 |
| 36 | 24 | DMC3624 | 16.00 | 23.50 | 0.74 | 0.61 | 1785 |
| 36 | 30 | DMC3630 | 20.00 | 23.50 | 0.74 | 0.66 | |
| 36 | 36 | DMC3636 | 26.00 | 26.00 | 0.74 | 0.74 | 2655 |
| 42 | 12 | DMC4212 | 12.50 | 27.50 | 0.82 | 0.42 | |
| 42 | 16 | DMC4216 | 13.00 | 27.50 | 0.82 | 0.50 | |
| 42 | 24 | DMC4224 | 20.00 | 27.50 | 0.82 | 0.61 | 2668 |
| 42 | 30 | DMC4230 | 22.00 | 29.50 | 0.82 | 0.66 | 2950 |
| 42 | 36 | DMC4236 | 30.00 | 30.00 | 0.82 | 0.74 | 3955 |
| 42 | 42 | DMC4242 | 30.00 | 30.00 | 0.82 | 0.82 | 3725 |
| 48 | 12 | DMC4812 | 12.50 | 32.00 | 0.90 | 0.42 | 1897 |
| 48 | 16 | DMC4816 | 23.00 | 32.00 | 0.90 | 0.50 | 2617 |
| 48 | 24 | DMC4824 | 23.00 | 32.00 | 0.90 | 0.61 | 2766 |
| 48 | 30 | DMC4830 | 23.00 | 32.00 | 0.90 | 0.66 | 4500 |
| 48 | 36 | DMC4836 | 33.50 | 32.25 | 0.90 | 0.74 | 3719 |
| 48 | 42 | DMC4842 | 33.5 | 33.5 | 0.90 | 0.82 | 4590 |
| 48 | 48 | DMC4848 | 33.5 | 33.5 | 0.90 | 0.90 | 4955 |

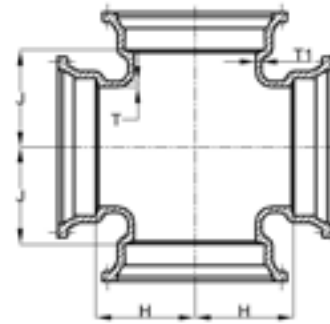

MJ Cross

Tees

| SIZE | | Item No. | Wt. | MJ x MJ | | | | MJ x Flange | | | |
|------|--------|----------|-----|---------|-------|------|------|-------------|-----|-------|-------|
| Run | Branch | | | H | J | T | T1 | Item No. | Wt. | H | L |
| 2 | 2 | DMT22 | 16 | 3.00 | 3.00 | 0.30 | 0.30 | | | | |
| 3 | 3 | DMT33 | 28 | 3.00 | 3.00 | 0.33 | 0.33 | DMF33 | 28 | 3.00 | 5.50 |
| 4 | 2 | DMT42 | 29 | 3.50 | 4.00 | 0.34 | 0.30 | | | | |
| 4 | 3 | DMT43 | 30 | 3.50 | 4.00 | 0.34 | 0.33 | DMF43 | 30 | 3.50 | 6.50 |
| 4 | 4 | DMT44 | 32 | 4.00 | 4.00 | 0.34 | 0.34 | DMF44 | 38 | 4.00 | 6.50 |
| 6 | 3 | DMT63 | 42 | 3.50 | 5.00 | 0.36 | 0.33 | DMF63 | 51 | 3.50 | 8.00 |
| 6 | 4 | DMT64 | 46 | 4.00 | 5.00 | 0.36 | 0.34 | DMF64 | 54 | 4.00 | 8.00 |
| 6 | 6 | DMT66 | 56 | 5.00 | 5.00 | 0.36 | 0.36 | DMF66 | 56 | 5.00 | 8.00 |
| 8 | 3 | DMT83 | 52 | 4.00 | 6.50 | 0.38 | 0.33 | DMF83 | 70 | 4.00 | 9.00 |
| 8 | 4 | DMT84 | 60 | 4.00 | 6.50 | 0.38 | 0.34 | DMF84 | 72 | 4.00 | 9.00 |
| 8 | 6 | DMT86 | 72 | 5.00 | 6.50 | 0.38 | 0.36 | DMF86 | 83 | 5.00 | 9.00 |
| 8 | 8 | DMT88 | 86 | 6.50 | 6.50 | 0.38 | 0.38 | DMF88 | 94 | 6.50 | 9.00 |
| 10 | 3 | DMT103 | 75 | 4.00 | 7.50 | 0.40 | 0.33 | | | | |
| 10 | 4 | DMT104 | 78 | 4.00 | 7.50 | 0.40 | 0.34 | DMF104 | 89 | 4.00 | 11.00 |
| 10 | 6 | DMT106 | 90 | 5.00 | 7.50 | 0.40 | 0.36 | DMF106 | 107 | 5.00 | 11.00 |
| 10 | 8 | DMT108 | 105 | 6.50 | 7.50 | 0.40 | 0.38 | DMF108 | 115 | 6.50 | 11.00 |
| 10 | 10 | DMT1010 | 120 | 7.50 | 7.50 | 0.40 | 0.40 | DMF1010 | 130 | 7.50 | 11.00 |
| 12 | 3 | DMT123 | 90 | 4.00 | 8.75 | 0.42 | 0.33 | | | | |
| 12 | 4 | DMT124 | 94 | 4.00 | 8.75 | 0.42 | 0.34 | DMF124 | 115 | 4.00 | 12.00 |
| 12 | 6 | DMT126 | 110 | 5.00 | 8.75 | 0.42 | 0.36 | DMF126 | 120 | 5.00 | 12.00 |
| 12 | 8 | DMT128 | 125 | 6.50 | 8.75 | 0.42 | 0.38 | DMF128 | 146 | 6.50 | 12.00 |
| 12 | 10 | DMT1210 | 140 | 7.50 | 8.75 | 0.42 | 0.40 | DMF1210 | 174 | 7.50 | 12.00 |
| 12 | 12 | DMT1212 | 160 | 8.75 | 8.75 | 0.42 | 0.42 | DMF1212 | 198 | 8.75 | 12.00 |
| 14 | 3 | DMT143 | | 5.50 | 10.50 | 0.47 | 0.33 | | | | |
| 14 | 4 | DMT144 | 172 | 5.50 | 10.50 | 0.47 | 0.34 | DMF144 | 161 | 5.50 | 14.00 |
| 14 | 6 | DMT146 | 182 | 6.50 | 10.50 | 0.47 | 0.36 | DMF146 | 177 | 6.50 | 14.00 |
| 14 | 8 | DMT148 | 206 | 7.50 | 10.50 | 0.47 | 0.38 | DMF148 | 199 | 7.50 | 14.00 |
| 14 | 10 | DMT1410 | 228 | 8.50 | 10.50 | 0.47 | 0.40 | DMF1410 | | 8.50 | 14.00 |
| 14 | 12 | DMT1412 | 234 | 9.50 | 10.50 | 0.47 | 0.42 | DMF1412 | | 9.50 | 14.00 |
| 14 | 14 | DMT1414 | 280 | 10.50 | 10.50 | 0.47 | 0.47 | DMF1414 | 277 | 10.50 | 14.00 |
| 16 | 3 | DMT163 | | 6.50 | 11.50 | 0.50 | 0.33 | | | | |
| 16 | 4 | DMT164 | 250 | 6.50 | 11.50 | 0.50 | 0.34 | | | | |
| 16 | 6 | DMT166 | 228 | 6.50 | 11.50 | 0.50 | 0.36 | DMF166 | 213 | 6.50 | 15.00 |
| 16 | 8 | DMT168 | 248 | 7.50 | 11.50 | 0.50 | 0.38 | DMF168 | 260 | 7.50 | 15.00 |

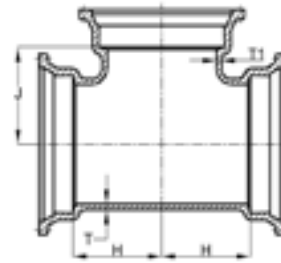

MJ x MJ

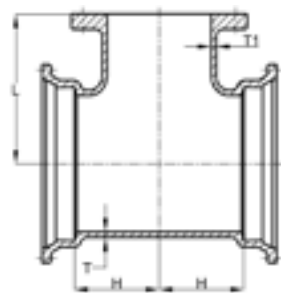

MJ x Flange

Tees (continued)

| SIZE | | Item No. | Wt. | MJ x MJ | | | | MJ x Flange | | | |
|------|--------|----------|------|---------|-------|------|------|-------------|------|-------|-------|
| Run | Branch | | | H | J | T | T1 | Item No. | Wt. | H | L |
| 16 | 10 | DMT1610 | 264 | 8.50 | 11.50 | 0.50 | 0.40 | DMF1610 | 287 | 8.50 | 15.00 |
| 16 | 12 | DMT1612 | 280 | 9.50 | 11.50 | 0.50 | 0.42 | DMF1612 | 312 | 9.50 | 15.00 |
| 16 | 14 | DMT1614 | 316 | 10.50 | 11.50 | 0.50 | 0.47 | DMF1614 | | 10.50 | 15.00 |
| 16 | 16 | DMT1616 | 322 | 11.50 | 11.50 | 0.50 | 0.50 | DMF1616 | | 11.50 | 15.00 |
| 18 | 6 | DMT186 | 275 | 6.50 | 12.50 | 0.54 | 0.36 | DMF186 | 261 | 6.50 | 15.50 |
| 18 | 8 | DMT188 | 295 | 7.50 | 12.50 | 0.54 | 0.38 | DMF188 | | 7.50 | 15.50 |
| 18 | 10 | DMT1810 | 315 | 8.50 | 12.50 | 0.54 | 0.40 | DMF1810 | | 8.50 | 15.50 |
| 18 | 12 | DMT1812 | 335 | 9.50 | 12.50 | 0.54 | 0.42 | DMF1812 | | 9.50 | 15.50 |
| 18 | 14 | DMT1814 | 380 | 10.50 | 12.50 | 0.54 | 0.47 | DMF1814 | | 10.50 | 16.50 |
| 18 | 16 | DMT1816 | 405 | 11.50 | 12.50 | 0.54 | 0.50 | DMF1816 | | 11.50 | 16.50 |
| 18 | 18 | DMT1818 | 435 | 12.50 | 12.50 | 0.54 | 0.54 | DMF1818 | | 12.50 | 16.50 |
| 20 | 6 | DMT206 | 315 | 6.50 | 14.00 | 0.57 | 0.36 | DMF206 | 345 | 6.50 | 17.00 |
| 20 | 8 | DMT208 | 345 | 8.00 | 14.00 | 0.57 | 0.38 | DMF208 | 384 | 8.00 | 17.00 |
| 20 | 10 | DMT2010 | 370 | 9.00 | 14.00 | 0.57 | 0.40 | DMF2010 | 367 | 9.00 | 17.00 |
| 20 | 12 | DMT2012 | 395 | 10.00 | 14.00 | 0.57 | 0.42 | DMF2012 | 402 | 10.00 | 17.00 |
| 20 | 14 | DMT2014 | 440 | 11.00 | 14.00 | 0.57 | 0.47 | DMF2014 | 435 | 11.00 | 17.00 |
| 20 | 16 | DMT2016 | 465 | 12.00 | 14.00 | 0.57 | 0.50 | DMF2016 | 477 | 12.00 | 18.00 |
| 20 | 18 | DMT2018 | 505 | 13.00 | 14.00 | 0.57 | 0.54 | DMF2018 | 507 | 13.00 | 18.00 |
| 20 | 20 | DMT2020 | 535 | 14.00 | 14.00 | 0.57 | 0.57 | DMF2020 | 554 | 14.00 | 18.00 |
| 24 | 6 | DMT246 | 415 | 7.00 | 16.00 | 0.61 | 0.36 | DMF246 | 460 | 7.00 | 19.00 |
| 24 | 8 | DMT248 | 445 | 8.00 | 16.00 | 0.61 | 0.38 | DMF248 | 418 | 8.00 | 19.00 |
| 24 | 10 | DMT2410 | 470 | 9.00 | 16.00 | 0.61 | 0.40 | DMF2410 | 462 | 9.00 | 19.00 |
| 24 | 12 | DMT2412 | 500 | 10.00 | 16.00 | 0.61 | 0.42 | DMF2412 | 502 | 10.00 | 19.00 |
| 24 | 14 | DMT2414 | 550 | 11.00 | 16.00 | 0.61 | 0.47 | DMF2414 | 539 | 11.00 | 19.00 |
| 24 | 16 | DMT2416 | 580 | 12.00 | 16.00 | 0.61 | 0.50 | DMF2416 | 579 | 12.00 | 19.00 |
| 24 | 18 | DMT2418 | 625 | 13.00 | 16.00 | 0.61 | 0.54 | DMF2418 | 634 | 13.00 | 22.00 |
| 24 | 20 | DMT2420 | 660 | 14.00 | 16.00 | 0.61 | 0.57 | DMF2420 | 686 | 14.00 | 22.00 |
| 24 | 24 | DMT2424 | 720 | 16.00 | 16.00 | 0.61 | 0.61 | DMF2424 | 789 | 16.00 | 22.00 |
| 30 | 6 | DMT306 | 700 | 8.50 | 20.00 | 0.66 | 0.36 | DMF306 | | 8.50 | 23.00 |
| 30 | 8 | DMT308 | 739 | 8.50 | 20.00 | 0.66 | 0.38 | DMF308 | | 8.50 | 23.00 |
| 30 | 10 | DMT3010 | 785 | 10.00 | 20.00 | 0.66 | 0.40 | | | | |
| 30 | 12 | DMT3012 | 830 | 10.00 | 20.00 | 0.66 | 0.42 | DMF3012 | | 10.00 | 23.00 |
| 30 | 16 | DMT3016 | 959 | 12.50 | 20.00 | 0.66 | 0.50 | DMF3016 | | 12.50 | 23.00 |
| 30 | 18 | DMT3018 | 1085 | 13.00 | 20.00 | 0.66 | 0.54 | | | | |
| 30 | 20 | DMT3020 | 995 | 15.00 | 20.00 | 0.66 | 0.57 | DMF3020 | | 15.00 | 23.00 |
| 30 | 24 | DMT3024 | 1060 | 16.00 | 20.00 | 0.66 | 0.61 | DMF3024 | | 16.00 | 25.00 |
| 30 | 30 | DMT3030 | 1323 | 20.00 | 20.00 | 0.66 | 0.66 | DMF3030 | 1267 | 20.00 | 25.00 |
| 36 | 6 | DMT366 | 1045 | 8.00 | 23.50 | 0.74 | 0.36 | | | | |
| 36 | 8 | DMT368 | 1095 | 9.00 | 23.50 | 0.74 | 0.38 | | | | |
| 36 | 10 | DMT3610 | 1184 | 10.00 | 23.50 | 0.74 | 0.40 | | | | |
| 36 | 12 | DMT3612 | 1205 | 10.00 | 23.50 | 0.74 | 0.42 | DMF3612 | 1034 | 10.00 | 26.00 |
| 36 | 14 | DMT3614 | 1112 | 12.50 | 23.50 | 0.74 | 0.47 | | | | |
| 36 | 16 | DMT3616 | 1385 | 12.50 | 23.50 | 0.74 | 0.50 | | | | |
| 36 | 18 | DMT3618 | 1455 | 13.00 | 23.50 | 0.74 | 0.54 | DMF3618 | 1307 | 16.00 | 26.00 |
| 36 | 20 | DMT3620 | 1631 | 15.00 | 23.50 | 0.74 | 0.57 | | | | |
| 36 | 24 | DMT3624 | 1498 | 16.00 | 23.50 | 0.74 | 0.61 | DMF3624 | | 16.00 | 26.00 |
| 36 | 30 | DMT3630 | 1555 | 20.00 | 23.50 | 0.74 | 0.66 | DMF3630 | | 20.00 | 28.00 |
| 36 | 36 | DMT3636 | 1900 | 23.50 | 23.50 | 0.74 | 0.74 | DMF3636 | 1924 | 23.50 | 28.00 |
| 42 | 6 | DMT426 | 1534 | 10.00 | 27.50 | 0.82 | 0.36 | | | | |
| 42 | 8 | DMT428 | 1347 | 10.00 | 27.50 | 0.82 | 0.38 | | | | |

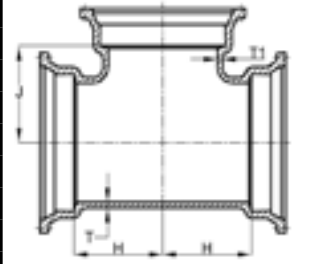

MJ x MJ

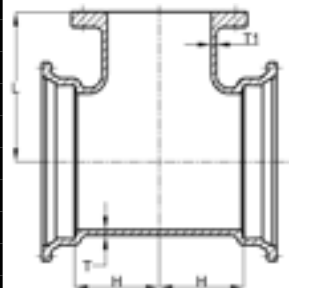

MJ x Flange

