

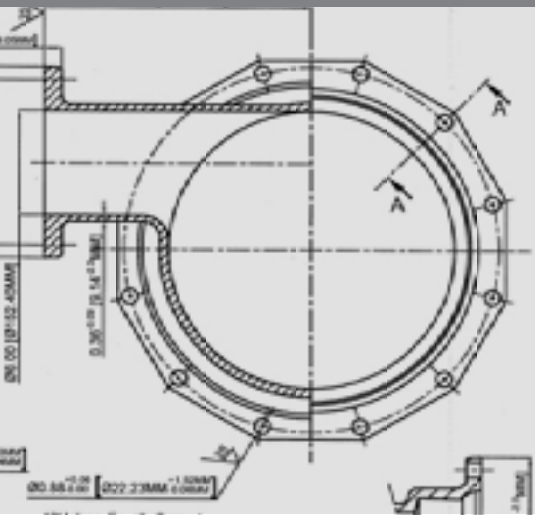

Quality – Service – Commitment – Delivered.

C153 DUCTILE IRON MECHANICAL JOINT FITTINGS



C153 DUCTILE IRON MECHANICAL JOINT FITTINGS BASIC SPECIFICATIONS

- SIZES:**
- 2" - 64"
- MATERIAL:**
- Ductile Iron ASTM A536, Grade 65-45-12, 60-42-10 or 70-50-05.
- PRESSURE:**
- 350 PSI Water Working Pressure 2" - 24".
 - 250 PSI Water Working Pressure 30" - 48".
 - 150 PSI Water Working Pressure 54" - 64".
- TESTING:**
- In accordance with ANSI/AWWA C153/A21.53.
 - In accordance with UL - FM requirements.
 - All fittings are hydrostatically tested in accordance with SIGMA Quality Management Standard.
 - All fittings are heat coded to ensure traceability and verification of metallurgical properties in accordance with the prevailing standards and SIGMA Quality Management Standards.
- LAYING LENGTH:**
- Short body design - straight section of body deleted to provide a compact and lighter fitting without reducing strength or flow characteristics.
- DEFLECTION:**
- In accordance with ANSI/AWWA C153/A21.53.
 - Maximum allowable deflection for MJ Joint on a full length pipe is as mentioned below:
 1. 3" - 4" = 8 Degrees
 2. 6" = 7 Degrees
 3. 8" - 12" = 5 Degrees
 4. 14" - 48" = 3 Degrees
- CEMENT LINING:**
- Double cement lined in accordance with ANSI/AWWA C104 / A21.4.
- COATING:**
- Interior of fitting is seal coated (asphaltic material) in accordance with ANSI AWWA C104/A21.4 and NSF61 approved.
 - Exterior of fitting is seal coated (asphaltic material) in accordance with ANSI/AWWA C153/A21.53 and NSF approved.
- GASKETS:**
- SBR in accordance with ANSI/AWWA C111/A21.11.
 - Also available in EPDM, NBR and CR.
- T-BOLTS:**
- Low Alloy corrosion resistant high strength steel in accordance with ANSI/AWWA C111/A21.11.
- APPROVALS:**
- 3"-16" Underwriters Laboratories listed and Factory Mutual Approved.
- STANDARDS:**
- Certified to NSF61 Standard including Annex G & 372.
 - ANSI/AWWA C153/A21.53 for Compact Ductile Iron Fittings 2"-64" for water and other liquids.
- INSTALLATION:**
- Per ANSI/AWWA C600 and C111 using DIP conforming to C150/C151 and PVC pipe conforming to C900/C905.

C153 DUCTILE IRON MECHANICAL JOINT FITTINGS



Quality – Service – Commitment – Delivered.

Offsets

MJ x MJ Size	Item No.	Wt.	D	L	L1	T	MJ x PE Item No.	Wt.
3 x 6	DMO36	30	6.00	9.00	14.50	0.33	DMQ36	29
3 x 12	DMO312	40	12.00	15.00	20.50	0.33	DMQ312	39
3 x 18	DMO318	49	18.00	21.00	26.50	0.33	DMQ318	48
3 x 24	DMO324	55	24.00	27.00	33.50	0.33	DMQ324	53
4 x 6	DMO46	45	6.00	10.00	15.50	0.34	DMQ46	44
4 x 12	DMO412	55	12.00	16.00	21.50	0.34	DMQ412	54
4 x 18	DMO418	65	18.00	22.00	27.50	0.34	DMQ418	63
4 x 24	DMO424	79	24.00	28.00	33.50	0.34	DMQ424	72
6 x 6	DMO66	45	6.00	12.00	17.50	0.36	DMQ66	55
6 x 12	DMO612	68	12.00	18.00	23.50	0.36	DMQ612	66
6 x 18	DMO618	86	18.00	24.00	29.50	0.36	DMQ618	103
6 x 24	DMO624	110	24.00	30.00	35.50	0.36	DMQ624	122
8 x 6	DMO86	84	6.00	13.00	18.50	0.38	DMQ86	85
8 x 12	DMO812	94	12.00	19.00	24.50	0.38	DMQ812	97
8 x 18	DMO818	110	18.00	25.00	30.50	0.38	DMQ818	133
8 x 24	DMO824	147	24.00	24.00	0.38			
10 x 6	DMO106	105	6.00	15.00	20.50	0.40	DMQ106	127
10 x 12	DMO1012	144	12.00	21.00	26.50	0.40	DMQ1012	174
10 x 18	DMO1018	165	18.00	27.00	32.50	0.40	DMQ1018	202
12 x 6	DMO126	150	6.00	17.00	22.50	0.42	DMQ126	132
12 x 12	DMO1212	153	12.00	23.00	28.50	0.42	DMQ1212	197
12 x 18	DMO1218	226	18.00	29.00	34.50	0.42	DMQ1218	273
12 x 24	DMO1224	272	24.00	35.00	40.50	0.42	DMQ1224	347
12 x 30	DMO1230	213	30.00	41.00	46.50	0.42	DMQ1230	205
14 x 6			6.00		24.00	0.47	DMQ146	
14 x 12			12.00		30.00	0.47	DMQ1412	
14 x 18			18.00		36.00	0.47	DMQ1418	
14 x 24			24.00		42.00	0.47	DMQ1424	
16 x 6			6.00		25.00	0.50	DMQ166	
16 x 12			12.00		31.00	0.50	DMQ1612	
16 x 18			18.00		37.00	0.50	DMQ1618	
16 x 24			24.00		43.00	0.50	DMQ1624	
18 x 6			6.00		25.00	0.54	DMQ186	
18 x 12			12.00		31.00	0.54	DMQ1812	
18 x 18			18.00		37.00	0.54	DMQ1818	
18 x 24			24.00		43.00	0.54	DMQ1824	
20 x 6			6.00		27.00	0.57	DMQ206	
20 x 12			12.00		33.00	0.57	DMQ2012	
20 x 18			18.00		39.00	0.57	DMQ2018	
20 x 24			24.00		45.00	0.57	DMQ2024	
24 x 6			6.00		28.00	0.61	DMQ246	
24 x 12			12.00		34.00	0.61	DMQ2412	
24 x 18			18.00		40.00	0.61	DMQ2418	
24 x 24			24.00		46.00	0.61	DMQ2424	

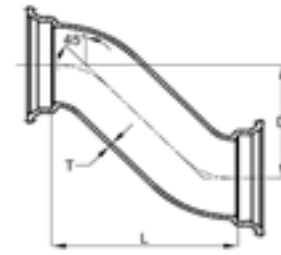

MJ x MJ

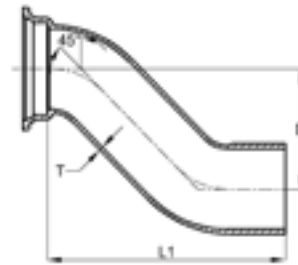

MJ x PE

Sleeves

Size	SHORT SLEEVE Item No.	Wt.	L	LONG SLEEVE Item No.	Wt.	L1	T
3	DMS3	13	7.50	DML3	18	12.00	0.33
4	DMS4	17	7.50	DML4	20	12.00	0.34
6	DMS6	28	7.50	DML6	33	12.00	0.36
8	DMS8	38	7.50	DML8	46	12.00	0.38
10	DMS10	49	7.50	DML10	62	12.00	0.40
12	DMS12	56	7.50	DML12	76	12.00	0.42
14	DMS14	111	9.50	DML14	140	15.00	0.47
16	DMS16	123	9.50	DML16	170	15.00	0.50
18	DMS18	160	9.00	DML18	200	15.00	0.54
20	DMS20	195	9.00	DML20	255	15.00	0.57
24	DMS24	226	9.00	DML24	335	15.00	0.61
30	DMS30	472	15.00	DML30	640	24.00	0.66
36	DMS36	673	15.00	DML36	925	24.00	0.74
42	DMS42	887	15.00	DML42	1390	24.00	0.82
48	DMS48	1136	15.00	DML48	1740	24.00	0.90

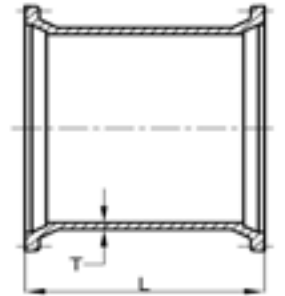

Short Sleeve

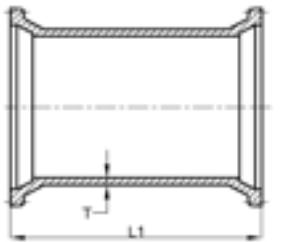

Long Sleeve

Dual Cutting-In Sleeves

Size	Item No.	Wt.	T	T1	A	L1
3	DCL3	34	0.33	0.35	3.96	20
4	DCL4	50	0.34	0.37	4.80	20
6	DCL6	62	0.36	0.39	6.90	20
8	DCL8	90	0.38	0.41	9.05	20
10	DCL10	105	0.40	0.43	11.10	20
12	DCL12	128	0.42	0.45	13.20	20

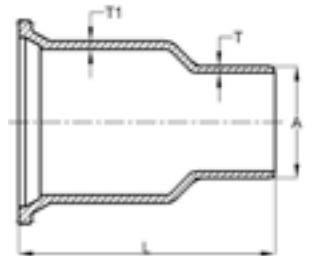

Dual Cutting- In Sleeves

