

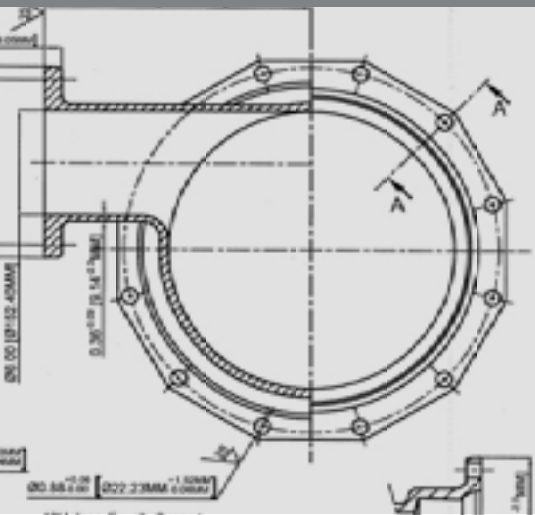

Quality – Service – Commitment – Delivered.

C153 DUCTILE IRON MECHANICAL JOINT FITTINGS



C153 DUCTILE IRON MECHANICAL JOINT FITTINGS BASIC SPECIFICATIONS

- SIZES:**
- 2" - 64"
- MATERIAL:**
- Ductile Iron ASTM A536, Grade 65-45-12, 60-42-10 or 70-50-05.
- PRESSURE:**
- 350 PSI Water Working Pressure 2" - 24".
 - 250 PSI Water Working Pressure 30" - 48".
 - 150 PSI Water Working Pressure 54" - 64".
- TESTING:**
- In accordance with ANSI/AWWA C153/A21.53.
 - In accordance with UL - FM requirements.
 - All fittings are hydrostatically tested in accordance with SIGMA Quality Management Standard.
 - All fittings are heat coded to ensure traceability and verification of metallurgical properties in accordance with the prevailing standards and SIGMA Quality Management Standards.
- LAYING LENGTH:**
- Short body design - straight section of body deleted to provide a compact and lighter fitting without reducing strength or flow characteristics.
- DEFLECTION:**
- In accordance with ANSI/AWWA C153/A21.53.
 - Maximum allowable deflection for MJ Joint on a full length pipe is as mentioned below:
 1. 3" - 4" = 8 Degrees
 2. 6" = 7 Degrees
 3. 8" - 12" = 5 Degrees
 4. 14" - 48" = 3 Degrees
- CEMENT LINING:**
- Double cement lined in accordance with ANSI/AWWA C104 / A21.4.
- COATING:**
- Interior of fitting is seal coated (asphaltic material) in accordance with ANSI AWWA C104/A21.4 and NSF61 approved.
 - Exterior of fitting is seal coated (asphaltic material) in accordance with ANSI/AWWA C153/A21.53 and NSF approved.
- GASKETS:**
- SBR in accordance with ANSI/AWWA C111/A21.11.
 - Also available in EPDM, NBR and CR.
- T-BOLTS:**
- Low Alloy corrosion resistant high strength steel in accordance with ANSI/AWWA C111/A21.11.
- APPROVALS:**
- 3"-16" Underwriters Laboratories listed and Factory Mutual Approved.
- STANDARDS:**
- Certified to NSF61 Standard including Annex G & 372.
 - ANSI/AWWA C153/A21.53 for Compact Ductile Iron Fittings 2"-64" for water and other liquids.
- INSTALLATION:**
- Per ANSI/AWWA C600 and C111 using DIP conforming to C150/C151 and PVC pipe conforming to C900/C905.

C153 DUCTILE IRON MECHANICAL JOINT FITTINGS

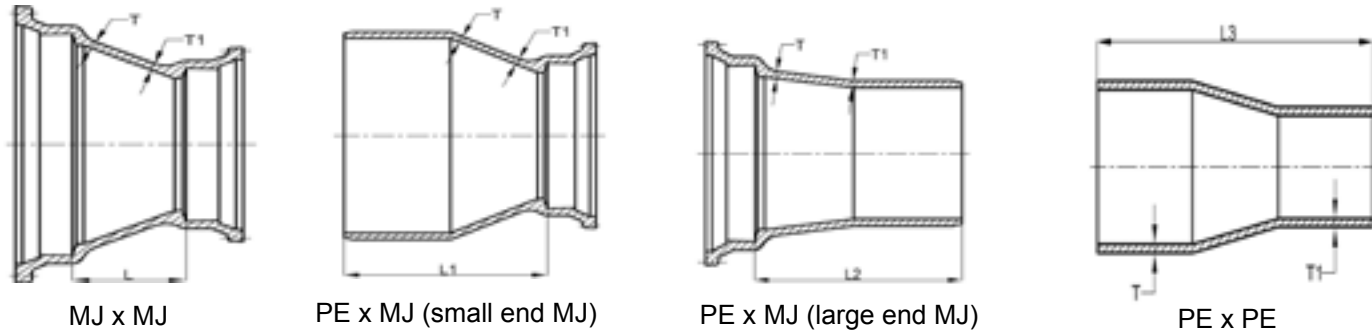

MJ x MJ

PE x MJ (small end MJ)

PE x MJ (large end MJ)

PE x PE

Reducers (continued)

Size	MJ x MJ			PE x MJ (Small End MJ)			MJ x PE (Large End MJ)			PE x PE				
	Item No.	Wt.	L	Item No.	Wt.	L1	Item No.	Wt.	L2	Item No.	Wt.	L3	T	T1
30 x 16	DMR3016	633	30.00	SPR3016	565	39.00	LPR3016	623	39.00	PPR3016	555	48.00	0.66	0.50
30 x 18	DMR3018	658	28.00	SPR3018	590	37.00	LPR3018	635	37.00	PPR3018	567	46.00	0.66	0.54
30 x 20	DMR3020	628	24.00	SPR3020	560	33.00	LPR3020	603	33.00	PPR3020	535	42.00	0.60	0.57
30 x 24	DMR3024	478	10.00	SPR3024	495	24.50	LPR3024	526	24.50	PPR3024	458	33.50	0.66	0.61
36 x 12	DMR3612	1058	30.00										0.74	0.42
36 x 16	DMR3616	1078	30.00										0.74	0.50
36 x 18	DMR3618	983	36.00										0.74	0.54
36 x 20	DMR3620	975	36.00	SPR3620	874	45.00	LPR3620	950	45.00	PPR3620	849	54.00	0.74	0.57
36 x 24	DMR3624	770	19.00	SPR3624	746	33.00	LPR3624	810	33.00	PPR3624	709	42.00	0.74	0.61
36 x 30	DMR3630	758	15.50	SPR3630	725	24.50	LPR3630	758	24.50	PPR3630	657	33.50	0.74	0.66
42 x 20	DMR4220		40.00										0.82	0.57
42 x 24	DMR4224	1356	40.00	SPR4224	1204	49.00	LPR4224	1319	49.00	PPR4224	1167	58.00	0.82	0.61
42 x 30	DMR4230	1083	20.00	SPR4230	931	29.00	LPR4230	1015	29.00	PPR4230	863	38.00	0.82	0.66
42 x 36	DMR4236	1114	15.50	SPR4236	962	24.50	LPR4236	1013	24.50	PPR4236	861	33.50	0.82	0.74
48 x 20	DMR4820	1462	40.00										0.90	0.57
48 x 24	DMR4824	1761	40.00										0.90	0.61
48 x 30	DMR4830	1779	40.00	SPR4830	1594	49.00	LPR4830	1711	49.00	PPR4830	1526	58.00	0.90	0.66
48 x 36	DMR4836	1641	28.00	SPR4836	1456	37.00	LPR4836	1540	37.00	PPR4836	1355	46.00	0.90	0.74
48 x 42	DMR4842	1426	15.50	SPR4842	1241	24.50	LPR4842	1274	24.50	PPR4842	1089	33.50	0.90	0.82

Tees: MJ x Swivel (Hydrant Tees)

Size	Item No.	H	S	T	T1	Wt.
6 x 4	DMH64	4.00	10.00	0.36	0.34	
6 x 6	DMH66	5.00	10.00	0.36	0.36	77
8 x 6	DMH86	5.00	11.00	0.38	0.36	89
8 x 8	DMH88	6.50	11.00	0.38	0.38	116
10 x 4	DMH104	4.00	12.50	0.40	0.34	
10 x 6	DMH106	5.00	12.50	0.40	0.36	113
10 x 8	DMH108	6.50	12.50	0.40	0.38	129
12 x 4	DMH124	4.00	13.50	0.42	0.34	
12 x 6	DMH126	5.00	13.50	0.42	0.36	128
12 x 8	DMH128	6.50	13.50	0.42	0.38	149
12 x 12	DMH1212	8.75	13.50	0.42	0.42	
14 x 6	DMH146	6.50	15.00	0.47	0.36	211
14 x 8	DMH148	7.50	15.00	0.47	0.38	182
16 x 6	DMH166	6.50	16.00	0.50	0.36	248
16 x 8	DMH168	7.50	16.00	0.50	0.38	298
18 x 6	DMH186	6.50	17.00	0.54	0.36	300
18 x 8	DMH188	7.50	17.00	0.54	0.38	272
20 x 6	DMH206	6.50	18.50	0.57	0.36	358
20 x 8	DMH208	8.00	18.50	0.57	0.38	382
24 x 6	DMH246	7.00	19.00	0.61	0.36	458
24 x 8	DMH248	8.00	19.00	0.61	0.38	477
30 x 6	DMH306	7.50	24.50	0.66	0.36	
36 x 6	DMH366	8.00	27.50	0.74	0.36	891
36 x 8	DMH368	9.00	27.50	0.74	0.38	936

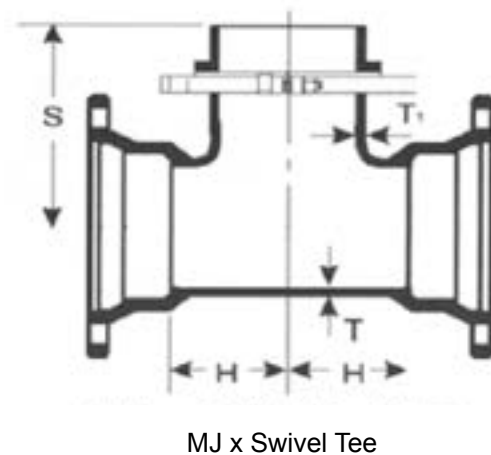

MJ x Swivel Tee

Swivel x Solid Adapter

Size	Item No.	L	T	Wt.
4	SSA413	13.00	0.34	29
6	SSA613	13.00	0.36	47
6	SSA618	18.00	0.36	58
6	SSA624	24.00	0.36	69
6	SSA630	30.00	0.36	66
6	SSA636	36.00	0.36	75
6	SSA648	48.00	0.36	94
6	SSA660	60.00	0.36	112
6	SSA672	72.00	0.36	131
8	SSA813	13.00	0.38	52
10	SSA1013	13.00	0.40	69
12	SSA1213	13.00	0.42	87

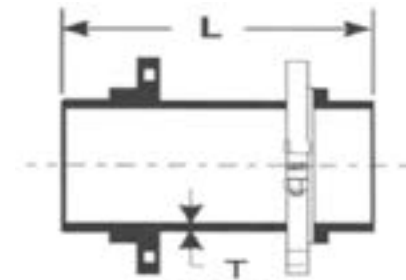

Swivel x Solid Adapter

Swivel Gland

Size	Item No.	Wt.
4	HR4	8
6	HR6	18
8	HR8	15
10	HR10	18
12	HR12	24

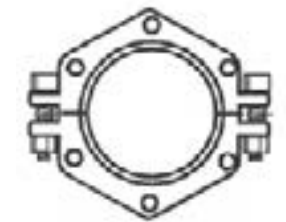

Swivel Gland

Dual Purpose Sleeves

Item No.	L1	T	Wt.
DDL4	12	0.52	32
DDL6	12	0.55	50
DDL8	12	0.60	65
DDL10	12	0.63	89
DDL12	12	0.68	104

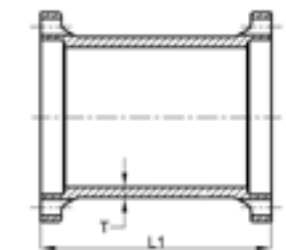

Dual Purpose Sleeves

Swivel x Solid 90° Bend

Size	Item No.	A	B	T	Wt.
3	SSB3	8.50	13.00	0.33	
4	SSB4	9.50	14.00	0.34	
6	SSB6	10.50	16.00	0.36	52
8	SSB8	12.50	18.00	0.38	74
10	SSB10	13.00	20.00	0.40	102
12	SSB12	14.50	22.00	0.42	
14	SSB14	19.50	24.00	0.47	
16	SSB16	20.50	26.00	0.50	
18	SSB18	21.00	28.00	0.54	
20	SSB20	22.50	30.00	0.57	
24	SSB24	25.00	34.00	0.61	
30	SSB30	30.50	40.00	0.66	
36	SSB36	33.50	46.00	0.74	
42	SSB42	38.25	52.00	0.82	
48	SSB48	42.25	58.00	0.90	

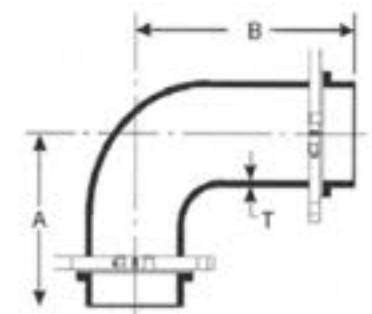

Swivel x Solid 90° Bend