

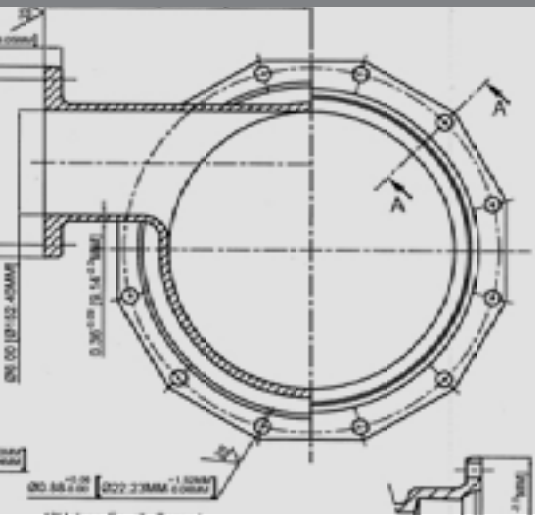

Quality – Service – Commitment – Delivered.

C153 DUCTILE IRON MECHANICAL JOINT FITTINGS



C153 DUCTILE IRON MECHANICAL JOINT FITTINGS BASIC SPECIFICATIONS

- SIZES:**
- 2" - 64"
- MATERIAL:**
- Ductile Iron ASTM A536, Grade 65-45-12, 60-42-10 or 70-50-05.
- PRESSURE:**
- 350 PSI Water Working Pressure 2" - 24".
 - 250 PSI Water Working Pressure 30" - 48".
 - 150 PSI Water Working Pressure 54" - 64".
- TESTING:**
- In accordance with ANSI/AWWA C153/A21.53.
 - In accordance with UL - FM requirements.
 - All fittings are hydrostatically tested in accordance with SIGMA Quality Management Standard.
 - All fittings are heat coded to ensure traceability and verification of metallurgical properties in accordance with the prevailing standards and SIGMA Quality Management Standards.
- LAYING LENGTH:**
- Short body design - straight section of body deleted to provide a compact and lighter fitting without reducing strength or flow characteristics.
- DEFLECTION:**
- In accordance with ANSI/AWWA C153/A21.53.
 - Maximum allowable deflection for MJ Joint on a full length pipe is as mentioned below:
 1. 3" - 4" = 8 Degrees
 2. 6" = 7 Degrees
 3. 8" - 12" = 5 Degrees
 4. 14" - 48" = 3 Degrees
- CEMENT LINING:**
- Double cement lined in accordance with ANSI/AWWA C104 / A21.4.
- COATING:**
- Interior of fitting is seal coated (asphaltic material) in accordance with ANSI AWWA C104/A21.4 and NSF61 approved.
 - Exterior of fitting is seal coated (asphaltic material) in accordance with ANSI/AWWA C153/A21.53 and NSF approved.
- GASKETS:**
- SBR in accordance with ANSI/AWWA C111/A21.11.
 - Also available in EPDM, NBR and CR.
- T-BOLTS:**
- Low Alloy corrosion resistant high strength steel in accordance with ANSI/AWWA C111/A21.11.
- APPROVALS:**
- 3"-16" Underwriters Laboratories listed and Factory Mutual Approved.
- STANDARDS:**
- Certified to NSF61 Standard including Annex G & 372.
 - ANSI/AWWA C153/A21.53 for Compact Ductile Iron Fittings 2"-64" for water and other liquids.
- INSTALLATION:**
- Per ANSI/AWWA C600 and C111 using DIP conforming to C150/C151 and PVC pipe conforming to C900/C905.

C153 DUCTILE IRON MECHANICAL JOINT FITTINGS

1/4 90° Bends

Size	MJ x MJ			MJ x PE				T
	Item No.	Wt.	A	Item No.	Wt.	A	B	
2	DMB290	17	3.00					0.30
3	DMB390	19	3.50	DME390	16	3.25	8.50	0.33
4	DMB490	25	4.00	DME490	22	4.00	9.50	0.34
6	DMB690	39	5.00	DME690	41	5.00	11.50	0.36
8	DMB890	57	6.50	DME890	58	6.50	12.50	0.38
10	DMB1090	89	7.50	DME1090	83	7.50	13.00	0.40
12	DMB1290	108	9.00	DME1290	114	9.00	14.50	0.42
14	DMB1490	210	11.50	DME1490	197	11.50	19.50	0.47
16	DMB1690	264	12.50	DME1690	248	12.50	20.50	0.50
18	DMB1890	335	14.00	DME1890	325	14.00	21.00	0.54
20	DMB2090	400	15.00	DME2090	390	15.00	22.50	0.57
24	DMB2490	565	16.75	DME2490	575	17.00	25.00	0.61
30	DMB3090	930	21.50	DME3090	865	21.50	30.50	0.66
36	DMB3690	1,450	24.50	DME3690	1,355	24.50	33.50	0.74
42	DMB4290	2,205	29.25	DME4290	2,055	29.25	38.25	0.82
48	DMB4890	2,990	33.25	DME4890	2,805	33.25	42.25	0.90



MJ x MJ Bend 90°



MJ x PE Bend 90°

1/8 45° Bends

Size	MJ x MJ			MJ x PE				T
	Item No.	Wt.	A	Item No.	Wt.	A	B	
2	DMB245	10	1.50					0.33
3	DMB345	16	1.50	DME345	13	1.50	7.00	0.33
4	DMB445	22	2.00	DME445	19	2.00	7.50	0.34
6	DMB645	32	3.00	DME645	34	3.00	8.50	0.36
8	DMB845	46	3.50	DME845	49	3.50	9.00	0.38
10	DMB1045	70	4.50	DME1045	69	4.50	10.00	0.40
12	DMB1245	86	5.50	DME1245	93	5.50	11.00	0.42
14	DMB1445	160	5.00	DME1445	146	5.00	13.00	0.47
16	DMB1645	202	5.50	DME1645	184	5.50	13.50	0.50
18	DMB1845	250	6.00	DME1845	235	6.00	13.00	0.54
20	DMB2045	305	7.00	DME2045	290	7.00	14.00	0.57
24	DMB2445	405	7.50	DME2445	390	7.50	14.50	0.61
30	DMB3045	780	10.50	DME3045	715	10.50	19.50	0.66
36	DMB3645	1135	11.50	DME3645	1,040	12.00	21.00	0.74
42	DMB4245	1610	14.00	DME4245	1,460	14.00	23.00	0.82
48	DMB4845	2090	15.00	DME4845	1,905	15.00	24.00	0.90

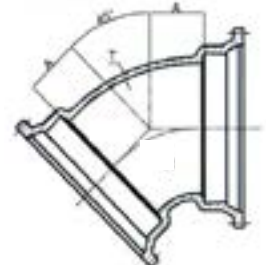

MJ x MJ Bend 45°

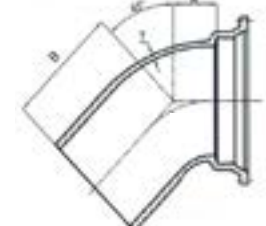

MJ x PE Bend 45°

1/16 22 1/2° Bends

Size	MJ x MJ			MJ x PE				T
	Item No.	Wt.	A	Item No.	Wt.	A	B	
2	DMB222		1.00					0.33
3	DMB322	15	1.00	DME322	12	1.00	6.50	0.33
4	DMB422	18	1.50	DME422	18	1.50	7.00	0.34
6	DMB622	31	2.00	DME622	29	2.00	7.50	0.36
8	DMB822	46	2.50	DME822	43	2.50	8.00	0.38
10	DMB1022	64	3.00	DME1022	61	3.00	8.50	0.40
12	DMB1222	80	3.50	DME1222	79	3.50	9.00	0.42
14	DMB1422	136	3.75	DME1422	133	3.75	11.25	0.47
16	DMB1622	172	3.75	DME1622	166	3.75	11.75	0.50
18	DMB1822	255	4.50	DME1822	235	6.00	13.00	0.54
20	DMB2022	310	4.50	DME2022	300	7.00	14.00	0.57
24	DMB2422	412	4.50	DME2422	395	7.50	14.50	0.61
30	DMB3022	665	6.75	DME3022	600	6.75	15.75	0.66
36	DMB3622	960	7.75	DME3622	865	7.75	16.75	0.74
42	DMB4222	1350	9.00	DME4222	1,200	9.00	18.00	0.82
48	DMB4822	1760	10.00	DME4822	1,575	10.00	19.00	0.90



MJ x MJ Bend 22-1/2°

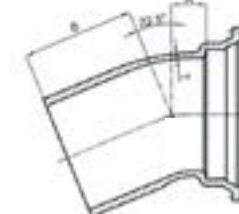

MJ x PE Bend 22-1/2°

1/32 1-1/4° Bends

Size	MJ x MJ			MJ x PE				T
	Item No.	Wt.	A	Item No.	Wt.	A	B	
3	DMB311	14	1.00	DME311	12	1.00	6.50	0.33
4	DMB411	16	1.25	DME411	17	1.25	6.25	0.34
6	DMB611	30	1.50	DME611	27	1.50	7.00	0.36
8	DMB811	42	1.75	DME811	39	1.75	7.25	0.38
10	DMB1011	58	2.00	DME1011	52	2.00	7.50	0.40
12	DMB1211	67	2.25	DME1211	69	2.25	7.75	0.42
14	DMB1411	93	2.50	DME1411	118	2.50	10.50	0.47
16	DMB1611	148	2.50	DME1611	136	2.50	10.50	0.50
18	DMB1811	205	3.00	DME1811	235	6.00	13.00	0.54
20	DMB2011	245	3.00	DME2011	300	7.00	14.00	0.57
24	DMB2411	315	3.00	DME2411	400	7.50	14.50	0.61
30	DMB3011	600	4.75	DME3011	535	4.75	13.75	0.66
36	DMB3611	820	5.00	DME3611	725	5.00	14.00	0.74
42	DMB4211	1180	6.00	DME4112	1,030	6.00	15.00	0.82
48	DMB4811	1475	6.50	DME4811	1,290	6.50	15.50	0.90



MJ x MJ 11-1/4° Bend

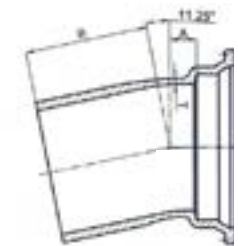

MJ x PE 11-1/4° Bend

90° Bends: MJ X Flange

Size	Item No.	A	S	T	Wt.
3	MFB390	3.50	5.50	0.33	21
4	MFB490	4.00	6.50	0.34	28
6	MFB690	5.00	8.00	0.36	46
8	MFB890	6.50	9.00	0.38	71
10	MFB1090	7.50	11.00	0.40	121
12	MFB1290	9.00	12.00	0.42	155
14	MFB1490	11.50	14.00	0.47	208
16	MFB1690	12.50	15.00	0.50	280
18	MFB1890	14.00	16.50	0.54	332
20	MFB2090	15.00	18.00	0.57	441
24	MFB2490	16.75	22.00	0.61	618
30	MFB3090	21.50	25.00	0.66	994
36	MFB3690	24.50	28.00	0.74	1462
42	MFB4290	29.25	31.00	0.82	2112
48	MFB4890	33.25	34.00	0.90	2816

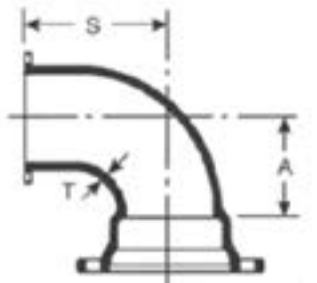

MJ x Flange 90° Bend

45° Bends: MJ x Flange

Size	Item No.	A	S	T	Wt.
3	MFB345	1.50	3.00	0.33	17
4	MFB445	2.00	4.00	0.34	34
6	MFB645	3.00	5.00	0.36	57
8	MFB845	3.50	5.50	0.38	83
10	MFB1045	4.50	6.50	0.40	122
12	MFB1245	5.50	7.50	0.42	159
14	MFB1445	5.00	7.50	0.47	162
16	MFB1645	5.50	8.00	0.50	290
18	MFB1845	6.00	8.50	0.54	252
20	MFB2045	7.00	9.50	0.57	338
24	MFB2445	7.50	11.00	0.61	442
30	MFB3045	10.50	15.00	0.66	765
36	MFB3645	11.50	18.00	0.74	1167
42	MFB4245	14.00	21.00	0.82	1720
48	MFB4845	15.00	24.00	0.90	2276

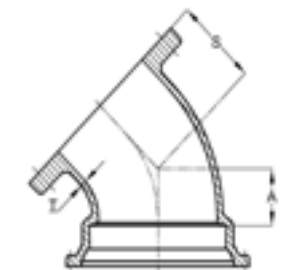

MJ x Flange 45° Bend