

Selkirk Model R Large Diameter Type B Gas Vent was designed with the installer in mind and to endure the elements. Lightweight construction with a small footprint, Selkirk Model R will deliver when space is tight but performance is essential. Easy to connect and assemble, you can count on a secure fit when installing Selkirk Model R



Selkirk's Model R Type B Gas Vent is listed and approved by UL for residential, commercial, and industrial applications. Selkirk Model R provides a continuous passageway from a Category 1 gas appliance, such as water heaters, boilers, and furnaces, to the termination of the vent above the roof of a structure.

Some of the safety features within Model R includes:

- Double wall construction with ½" air space
- Clearance to combustibles standards of:
  - 1" in the United States for all diameters
  - 1" in Canada for diameters 10" to 24"
  - 2" in Canada for diameters 26" to 30"
- Galvanized steel outer wall construction for exceptional corrosion resistance \*exterior applications must be painted in Canada\*
- Aluminum inner wall construction to keep flue gases hot



Model R is to be installed in single and multi-story buildings in accordance with the following Natural Gas & Propane Codes:  
 USA: NFPA 54  
 CANADA: CAN/CSA B149.1 & .2

Selkirk Model R is accepted by: AGA, NFPA, HUD, NBC, UBC



## ***Why Selkirk Model R?***

### **Lightweight**

We keep the connections clean to reduce the weight of the pipe making installation a SNAP (twist–snap that is).

### **Smaller footprint**

Clean connections coupled with a ½" air space tighten the diameter of the pipe to create a solid connection suitable for tight spaces.

### **Easy to connect**

Model R's snap lock coupling system creates a secure, confident connection. Simply align the seams, twist, and SNAP – ready to go!

### **Backed by an exceptional warranty**

We are so confident in Selkirk Model R's ability to satisfy, we've backed it by the industry's finest warranty, the Smart Choice Warranty.

## 45° Elbow

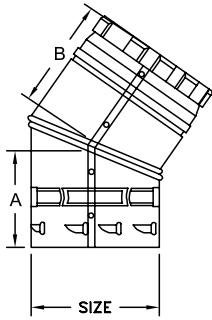

- Elbows are used to offset installation to avoid obstructions such as rafters and joists
- Size 10" through 14" adjust easily from 0° to 45°
- Sizes 16" through 30" are non-adjustable
- See the Gas Vent Offset Table on page 9

Code	Part #	Size	A	B	Adjustable
2003623	10R45-S	10"	5 <sup>7</sup> / <sub>8</sub> "	5 <sup>3</sup> / <sub>8</sub> "	0° - 45°
2003641	12R45-S	12"	6"	5 <sup>3</sup> / <sub>8</sub> "	0° - 45°
2003680	14R45-S	14"	6 <sup>5</sup> / <sub>8</sub> "	6 <sup>1</sup> / <sub>2</sub> "	0° - 45°
2003698	16R45-S	16"	7"	7"	NON
2003716	18R45-S	18"	7 <sup>1</sup> / <sub>2</sub> "	7 <sup>1</sup> / <sub>2</sub> "	NON
2003734	20R45-S	20"	8"	7 <sup>5</sup> / <sub>8</sub> "	NON
2003752	22R45-S	22"	8 <sup>1</sup> / <sub>2</sub> "	8 <sup>5</sup> / <sub>8</sub> "	NON
2003769	24R45-S	24"	8 <sup>5</sup> / <sub>8</sub> "	8 <sup>15</sup> / <sub>16</sub> "	NON
2003785	26R45-S	26"	9"	9"	NON
2003800	28R45-S	28"	9 <sup>1</sup> / <sub>2</sub> "	9"	NON
2004004	30R45-S	30"	10"	10"	NON

## Tee

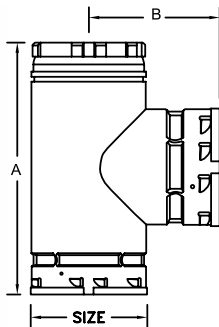

- A tee transitions a system from horizontal to vertical orientation
- Branch and trunk diameters of the standard tee are the same size

Code	Part #	Size	A	B
2003629	10RT-S	10"	16"	8 <sup>1</sup> / <sub>16</sub> "
2003647	12RT-S	12"	17 <sup>9</sup> / <sub>16</sub> "	9 <sup>3</sup> / <sub>4</sub> "
2003686	14RT-S	14"	24"	11 <sup>3</sup> / <sub>4</sub> "
2003704	16RT-S	16"	26"	13"
2003722	18RT-S	18"	28 <sup>1</sup> / <sub>2</sub> "	14 <sup>1</sup> / <sub>4</sub> "
2003740	20RT-S	20"	30"	15 <sup>1</sup> / <sub>2</sub> "
2003758	22RT-S	22"	33"	16 <sup>3</sup> / <sub>4</sub> "
2003775	24RT-S	24"	36"	18"
2003791	26RT-S	26"	38"	19"
2003806	28RT-S	28"	40"	20"
2003818	30RT-S	30"	42"	21"

## Tee Cap

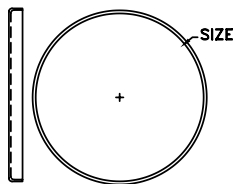

- The Tee Cap is used to close the bottom or branch of the Tee

Code	Part #	Size
2003630	10RTC-S	10"
2003648	12RTC-S	12"
2003687	14RTC-S	14"
2003705	16RTC-S	16"
2003723	18RTC-S	18"
2003741	20RTC-S	20"
2003759	22RTC-S	22"
2003776	24RTC-S	24"
2003792	26RTC-S	26"
2003807	28RTC-S	28"
2003819	30RTC-S	30"