

TEMPERATURE LIMIT CONTROL SWITCHES

LIMIT CONTROL SWITCHES – MANUAL RESET

Limit Control Switches – Manual Reset

(Flangeless Surface Mount – 60T)

THERMODISC



PART NO	TOD SWITCH SERIES	OPEN TEMP (°F)	TOLERANCE OPEN TEMP (°F)	MAX VOLTAGE RATING (VAC)	MAX CURRENT RATING (A)	COLOR CODE	DISC FACE	SWITCH TYPE	CONTACT ORIENT
47-22712-82	60T	310	+/-8	230	25	Red	Enclosed	SPST	Normally Closed

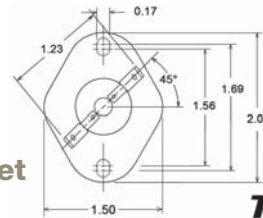

Limit Control Switches – Manual Reset

(Flanged Surface Mount – 36T)

THERMODISC



PART NO	TOD SWITCH SERIES	OPEN TEMP (°F)	TOLERANCE OPEN TEMP (°F)	MAX VOLTAGE RATING (VAC)	MAX CURRENT RATING (A)	COLOR CODE	DISC FACE	SWITCH TYPE	CONTACT ORIENT
47-22906-02	36T	190	+/-10	120 / 230	15 / 10		Enclosed	SPST	Normally Closed

LIMIT CONTROL SWITCHES – NONRESETTABLE

Limit Control Switches –

Non-Resettable (Flanged Airstream – 61F)

THERMODISC

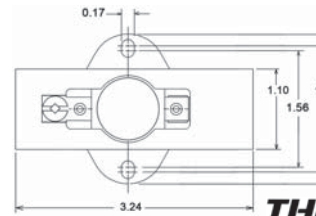

PART NO	TOD SWITCH SERIES	OPEN TEMP (°F)	TOLERANCE OPEN TEMP (°F)	MAX VOLTAGE RATING (VAC)	MAX CURRENT RATING (A)	DISC FACE	SWITCH TYPE	CONTACT ORIENT	MOUNTING INSERTION DEPTH MAX (IN)
470027	61F	225	+/-10	575	48	Enclosed	SPST	Normally Closed	3/8
47-41590-02	61F	300	+/-8	575	48	Enclosed	SPST	Normally Closed	3/8
47-41590-03	61F	325	+/-12	575	48	Enclosed	SPST	Normally Closed	3/8

Limit Control Switches –

Non-Resettable (Flanged Airstream – 60F)

THERMODISC

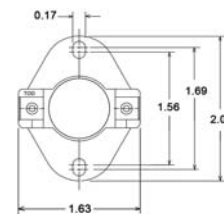

PART NO	TOD SWITCH SERIES	OPEN TEMP (°F)	TOLERANCE OPEN TEMP (°F)	MAX VOLTAGE RATING (VAC)	MAX CURRENT RATING (A)	DISC FACE	SWITCH TYPE	CONTACT ORIENT	MOUNTING INSERTION DEPTH MAX (IN)
470032	60F	208	+/-10	575	25	Exposed	SPST	Normally Closed	3/8
470034	60F	200	+/-8	575	25	Exposed	SPST	Normally Closed	3/8

TEMPERATURE LIMIT CONTROLS

Temperature Limit Controls – Fuse Links



PART NO	VENDOR PART NO	TEMP RATING(°F)	RESISTIVE RATING @120V (°F)	RESISTIVE RATING @120V (°F)
PD442006	G5AM0602141C	285	25	21
44-20037-03	G4AM0600167C482643	333	15	10