

## MIP NON-SERVICEABLE BALL VALVE

PVC SCHEDULE 40 SOCKETS  
 RATED @150 PSI @ 72°F STATIC PRESSURE  
 VALVE BODY, BALL, HANDLE & STEM ARE PVC  
 BUNA OR TEFLON BALL SEAT  
 EPDM O-RING  
 ABS CAP

IPS—IRON PIPE SIZE  
 (SAME AS SCHEDULE 40 PIPE)  
 FPT—FEMALE PIPE THREAD

2" AND SMALLER VALVES HAVE TWO-SIDED HANDLE  
 2.5" AND LARGER HAVE SINGLE LEVER HANDLE

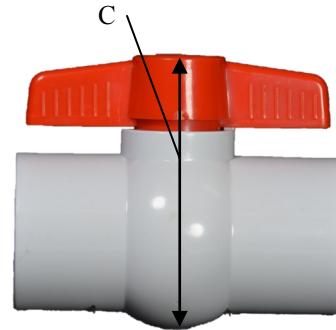
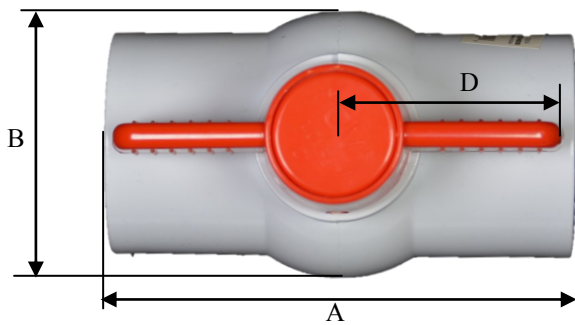
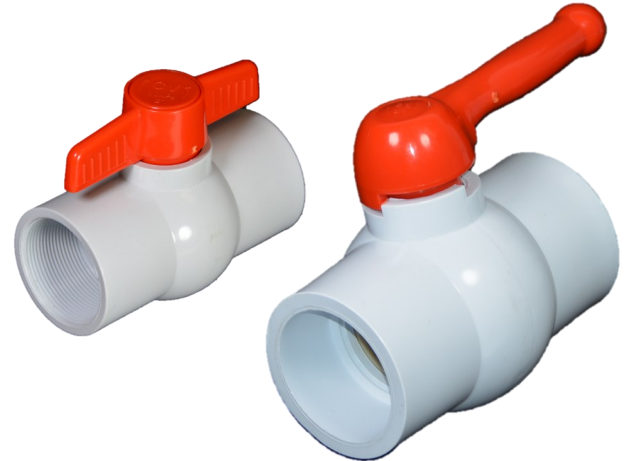

PART NUMBER		A (INCHES)	B (INCHES)	C (INCHES)	D (INCHES)	WEIGHT (LBS)	IPS CONNECTION
SLIP	FPT						
E1310-05	E1320-05	2.98	1.45	2.47	1.33	0.15	1/2" IPS
E1310-07	E1320-07	3.49	1.74	2.89	1.56	0.25	3/4" IPS
E1310-10	E1320-10	3.96	2.17	3.58	1.86	0.40	1" IPS
E1310-12	E1320-12	4.43	2.69	4.13	2.22	0.70	1 1/4" IPS
E1310-15	E1320-15	4.80	2.79	4.21	2.22	0.75	1 1/2" IPS
E1310-20	E1320-20	5.40	3.37	4.85	2.66	1.15	2" IPS
E1310-25	E1320-25	7.00	4.52	6.51	6.35	3.05	2 1/2" IPS
E1310-30	E1320-30	8.22	5.13	7.22	6.35	3.90	3" IPS
E1310-40	E1320-40	11.53	6.50	9.00	8.50	8.95	4" IPS
E1310-60	N/A	15.88	9.50	12.00	10.15	21.25	6" IPS

