

# DIMENSIONAL SPECIFICATIONS

LEAD-FREE IMPORT BRASS FITTINGS\* 125 LB.

## 90 DEGREE REDUCING ELBOW

Part #	Size (IN.)	Approx. Net WT. (LB.)	A	B	C
XNL101-0402	1/4 X 1/8	0.09	0.67	0.81	0.88
XNL101-0604	3/8 X 1/4	0.15	0.81	1.00	0.92
XNL101-0806	1/2 X 3/8	0.23	0.81	1.17	1.17
XNL101-1204	3/4 X 1/4	0.26	0.81	1.42	1.35
XNL101-1206	3/4 X 3/8	0.30	1.00	1.42	1.35
XNL101-1208	3/4 X 1/2	0.31	1.17	1.42	1.35
XNL101-1608	1 X 1/2	0.53	1.17	1.72	1.56
XNL101-1612	1 X 3/4	0.59	1.42	1.72	1.56
XNL101-2012	1-1/4 X 3/4	0.73	1.42	2.10	1.77
XNL101-2016	1-1/4 X 1	0.88	1.72	2.10	1.77
XNL101-2412	1-1/2 X 3/4	1.00	1.72	2.10	1.77
XNL101-2416	1-1/2 X 1	0.99	1.72	2.38	1.80
XNL101-2420	1-1/2 X 1-1/4	1.22	2.10	2.38	1.80
XNL101-3212	2 X 3/4	1.21	2.10	2.92	2.03
XNL101-3216	2 X 1	1.30	2.10	2.92	2.03
XNL101-3220	2 X 1-1/4	1.51	2.10	2.92	2.03
XNL101-3224	2 X 1-1/2	1.69	2.38	2.92	2.03
XNL101-4032	2-1/2 X 2	1.21	2.92	3.49	3.15
XNL101-4840	3 X 2-1/2	4.09	3.49	4.20	3.69

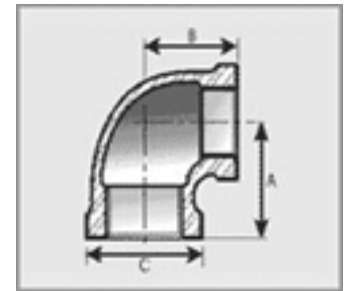

\*Conforms with lead content requirements for lead-free plumbing as defined by the U.S. Safe Drinking Water Act. Certified <0.25 weighted average % lead.



# MERIT BRASS

DIRECTING THE FLOW OF *Quality*