

**RECTANGULAR DUCT PRODUCTS**

**Hollow Turning Vane, Pro Rail and Connectors - 10' Lengths (Unless otherwise noted)**

<u>Size</u>	<u>P/N</u>
2"	RD-HTV2
4"	RD-HTV4

**Hollow Turning Vane**



<u>Size</u>	<u>P/N</u>
2"	RD-PVR224
4"	RD-PVR422

**Pro Rail (Boxed)**

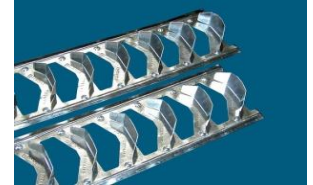

<u>Gauge</u>	<u>P/N</u>	<u>Length</u>
26 ga	RD-FD26	5'
26 ga	RD-FD26E	
24 ga	RD-FD24	5'
24 ga	RD-FD24E	

**Flat Drives**

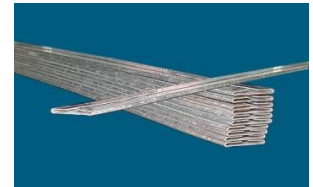

<u>Gauge</u>	<u>P/N</u>
24 ga	RD-SD24
22 ga	RD-SD22

**1" Standing Drives**



<u>Gauge</u>	<u>P/N</u>	<u>Length</u>
26 ga	RD-FS26	5'
26 ga	RD-FS26E	
24 ga	RD-FS24	5'
24 ga	RD-FS24E	

**Flat Esses**



<u>Gauge</u>	<u>P/N</u>
26 ga	RD-SS2611/8
26 ga	<b>RD-SS2611/8-A</b>
24 ga	RD-SS2411/8
24 ga	<b>RD-SS2411/8-A</b>
22 ga	RD-SS2211/8
22 ga	<b>RD-SS2211/8-A</b>

**1 1/8" Standing Esses**

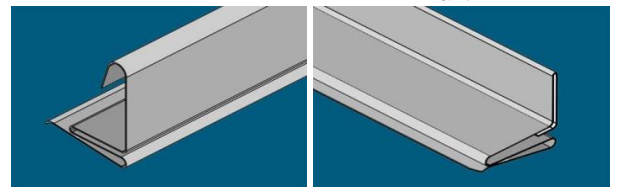

<u>Gauge</u>	<u>P/N</u>
24 ga	RD-SS2415/8
22 ga	RD-SS2215/8
20 ga	RD-SS2015/8

**1 5/8" Standing Esses**

