

# UP Comfort System

## UP 15-10 SU7P/TLC

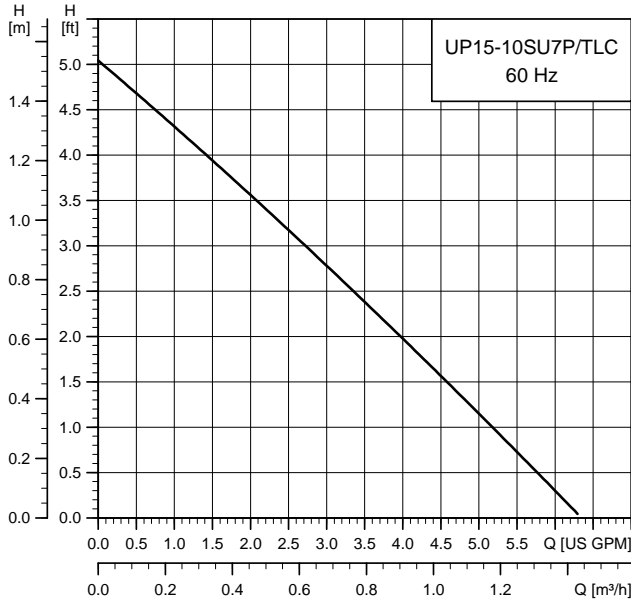

TM03 5547 4412

Flow range: 0-6.3 gpm (0-1.4 m³h)  
 Head range: 0-5.1 ft (0-1.6 m)  
 Motors: 2-pole, single-phase  
 Max. liquid temperature: 150 °F (66 °C)  
 Min. liquid temperature: 36 °F (2 °C)  
 Max. system pressure: 145 psi (10 bar)  
 Open system

Model	Volts	Amps	Watts	Hp	Capacitor
UP 15-10 SU7P/TLC	115	0.23	25	1/25	2µF/400 V

### Approvals



UP 15-10 SU7P/TLC

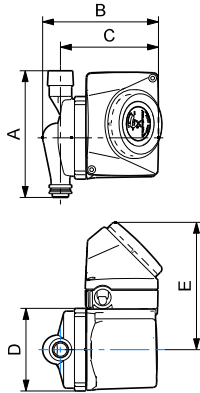

TM03 4362 3507

Comfort Valve®

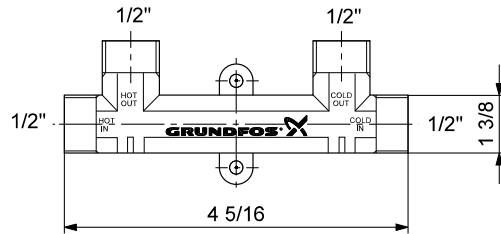

TM03 4363 3507

Model type	Product number	Dimensions [inches (mm)]						Connection type and size	Shipping weight [lbs (kg)]
		A	B	C	D	E	F		
UP 15-10 SU7P/TLC	595916	5.44 (138)	6.25 (159)	5.50 (140)	3.44 (87)	3.25 (83)	4.00 (102)	3/4" M x 3/4" F NPT	5.5 (2.5)
Comfort Valve	595926	—	—	—	—	—	—	1/2" M NPS (1/2" faucet)	2.8 (1.3)
Flex Hose Kit	599390	—	—	—	—	—	—	(2) 1/2" FNPS X 1/2" FNPS X 12" flex hoses	-

Model type	Product number	Description
Comfort Valves	595926	Box of 15 pieces
Comfort Series Kit	595916	1 pump and 1 valve, (2) 1/2" FNPS X 1/2" FNPS X 12" flex hoses

**Note:** All models have a 10 ft (3 m), 3-prong power cord. Dimensions in inches unless otherwise noted.