



K-59 3-1/2" GOOSENECK SPLASH MOUNT FAUCET

Meets All Federal Lead Free Standards



Click This Link To View Assembly Sheet

Item #: _____ Qty #: _____
 Model #: _____
 Project #: _____

FEATURES:

- 3-1/2" swivel gooseneck spout.
- 4" O.C. water supply.
- Quarter-turn wedge style handles.
- Colored hot & cold Indexes.
- 1.0 GPM/3.8 LPM Aerator. 60 PSI.

MATERIAL:

- Brass chrome plated body & spout.
- Chrome plated handles.

FAUCET AERATOR CONFORM TO
 ASTM.A112.18.1M • 1.0 GPM/3.8 LP
 THREAD: 55/64 - 27 FEMALE

DIMENSIONS and SPECIFICATIONS

Options & Accessories

Replacement Spout For K-59 Faucet

3-1/2" Gooseneck Spout Only.



K-59SPH

Replacement Cartridges For K-59 Faucet

*Can Only Be Used On Faucets Purchased After January 2016. For Older Faucets, Consult Customer Service.



K-00HA (Set of 2)

Wrist Handles For Existing K-59 Faucet

*Can Only Be Used On Faucets Purchased After January 2016. For Older Faucets, Consult Customer Service.



K-316-LUHA (Set of 2)

For a Complete faucet with Wrist Handles, See our **K-316** Spec Sheet.

Low Flow Aerator

.5 GPM



K-08

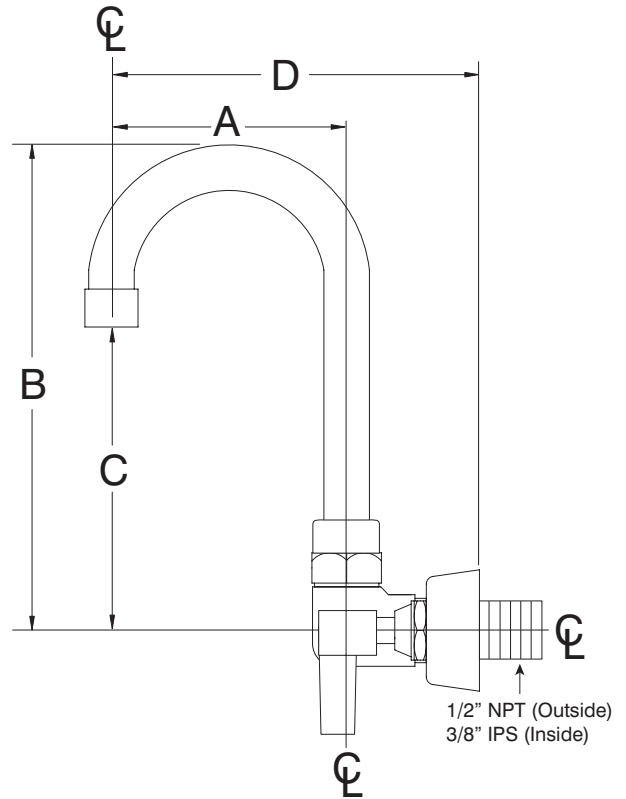

| A Length | B Height | C | D | On Center Dimensions |
|----------|----------|--------|--------|----------------------|
| 3 1/2" | 8 3/8" | 5 1/2" | 5 3/4" | 4" O.C. |



Customer Service Available To Assist You **1-800-645-3166** 8:30 am - 8:00 pm E.S.T.

For Orders & Customer Service:

Email: customer@advancetabco.com or Fax: 631-242-6900

For Smart Fabrication™ Quotes:

Email: smartfab@advancetabco.com or Fax: 631-586-2933