

- The Model 2210/2410 is a whole house air cleaner.
- Permanently traps and removes 93% of pollen-sized particles (5.0 microns).
- Traps and permanently removes 91% of mold- and spore-sized particles (3.0 microns).
- Recommended air flow is up to 2000 cfm.
- Resistance with a new media ranges from 0.06" w.c. at 800 cfm to 0.27" w.c. at 2000 cfm.
- Unit operation is completely silent.
- The only maintenance required is replacement of the disposable media.
- Media replacement is recommended after one to two years depending on air flow.
- Replacement Media is #213 for the 2210, and #413 for the 2410.
- Outer housing is heavy gauge, preassembled galvanized steel, with an electrostatic painted finish.
- Door is attached with two sturdy spring steel clips and four alignment tabs for easy closure.
- Warranted for five (5) years from the date of installation to be free from defects in materials or workmanship, except, however, for the disposable media .
- UL classified.



2210/2410 UNITS

| PRODUCT SPECIFICATIONS | | | | |
|------------------------------------|--|-----------|--------------------|-------------------------|
| MEDIA AIR CLEANER Model 2210 | RESISTANCE @ AIRFLOW VOLUME (inches w.c. @CFM) | | SHIPPING WEIGHT | FILTERING MEDIA AREA |
| | .04"@600 | .13"@1400 | | |
| | .06"@800 | .16"@1600 | 18 lbs. | 31.4 sq. ft. |
| | .08"@1000 | .19"@1800 | | |
| | .11"@1200 | .22"@2000 | | |
| MEDIA AIR CLEANER Model 2410 | RESISTANCE @ AIRFLOW VOLUME (inches w.c. @CFM) | | SHIPPING WEIGHT | FILTERING MEDIA AREA |
| | .05"@600 | .15"@1400 | | |
| | .07"@800 | .19"@1600 | 17 lbs. | 28.3 sq. ft. |
| | .09"@1000 | .22"@1800 | | |
| | .12"@1200 | .27"@2000 | | |

213/413 UPGRADE MEDIA

| PRODUCT SPECIFICATIONS | | | | |
|-------------------------------|--|-----------|--------------------|-------------------------|
| UPGRADE MEDIA Model 213 | RESISTANCE @ AIRFLOW VOLUME (inches w.c. @CFM) | | SHIPPING WEIGHT | FILTERING MEDIA AREA |
| | .06"@600 | .20"@1400 | | |
| | .09"@800 | .25"@1600 | 19.2 lbs. | 30 sq. ft. |
| | .12"@1000 | .30"@1800 | | |
| | .16"@1200 | .35"@2000 | | |
| UPGRADE MEDIA Model 413 | RESISTANCE @ AIRFLOW VOLUME (inches w.c. @CFM) | | SHIPPING WEIGHT | FILTERING MEDIA AREA |
| | .06"@600 | .22"@1400 | | |
| | .09"@800 | .26"@1600 | 18.4 lbs. | 26.8 sq. ft. |
| | .12"@1000 | .31"@1800 | | |
| | .17"@1200 | .37"@2000 | | |



APRILAIRE MODEL 2210/2410 MEDIA AIR CLEANERS

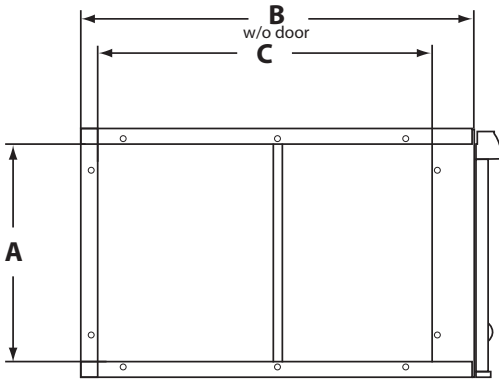

Outlet Side
Furnace Connection

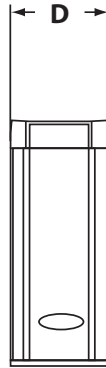

Front

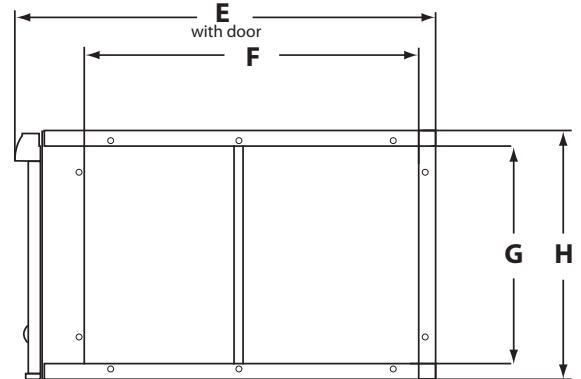

Inlet Side
Return Duct Connection

| Dimension | Description | Model 2210 | Model 2410 |
|-----------|----------------------------------|----------------|----------------|
| A | Outlet Opening Height | 19.75" (502mm) | 15.44" (392mm) |
| B | Outer Housing Depth Without Door | 25.38" (645mm) | 28.06" (713mm) |
| C | Outlet Opening Width | 21.19" (557mm) | 23.88" (625mm) |
| D | Unit Width | 6.75" (254mm) | 6.75" (254mm) |
| E | Outer Housing Depth With Door | 27.38" (679mm) | 30.06" (749mm) |
| F | Inlet Opening Width | 21.19" (502mm) | 23.88" (606mm) |
| G | Inlet Opening Height | 19.75" (546mm) | 15.44" (392mm) |
| H | Unit Height | 22.06" (560mm) | 17.75" (451mm) |

Clean Air

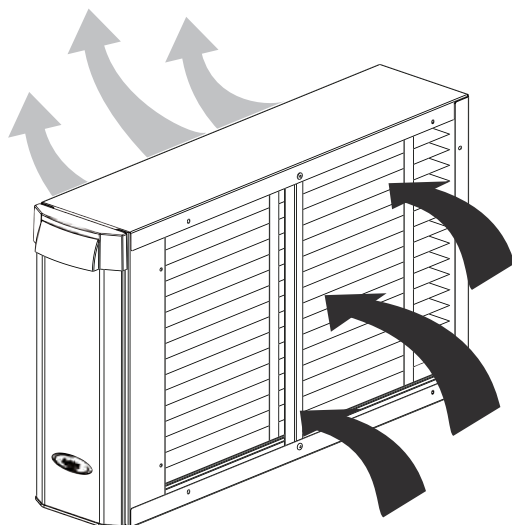

Dirt
Pet Dander
Allergens
Chemicals
Pollen

REPLACEMENT MEDIA

MODEL 2210 - APRILAIRE PART # 213

MODEL 2410 - APRILAIRE PART # 413

RESEARCH PRODUCTS RESERVES THE RIGHT TO CHANGE SPECIFICATIONS WITHOUT NOTICE.