

## CODE NUMBER

0326045PK

## DESCRIPTION

Thermostatic mixing valve supplied with Sloan Optima® and Optima Plus® faucets that are specified with the "BDT" (Below Deck Thermostatic) variation, or available separately.

## FEATURES

### MIX-135-A Thermostatic Water Mixing Valve with the following features:

- Designed for under-the-lavatory applications where the outlet temperature of hot water must be controlled for safe, economic use.
- Installs in place of the Tee fitting supplied with the faucet prior to the solenoid valve
- Designed to quickly sense and compensate for temperature fluctuations induced by water temperature and pressure changes in the supply line
- Rugged construction features solid brass valve body and corrosion resistant internal components
- Water temperature adjustment stem with lock nut to prevent tampering
- Equipped with integral check valves at inlets
- 3/8" compression connection on inlets and outlet
- Meets all the performance standards of ASSE 1070 and CSA B125
- Capacity — standard: .....4.0 gpm (15.0 Lpm) †
- Maximum Hot Water Supply Temperature:.....180° F (82° C)
- Minimum Hot Water Supply Temperature:.....5° F (2.8° C) above set point
- Maximum Operating Pressure: .....125 psig (862kPa)
- Minimum flow — standard:.....0.25 gpm (1.0 Lpm) to ASSE 1016
- Factory set: .....105° F (40° C)
- † At 45 PSI differential (310 kPa), with hot water supply between 140°-180° F (60°-82° C).

## NOTES

All information contained within this document subject to change without notice.

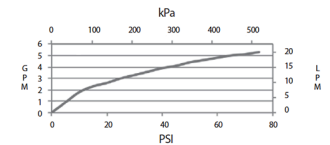
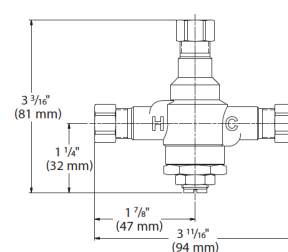

## COMPLIANCES & CERTIFICATIONS



(UPC Low Lead Compliant, ASSE 1070)

Sloan 10500 Seymour Ave, Franklin Park, IL 60131

Phone: 800.982.5839 • Fax: 800.447.8329 • [sloan.com](http://sloan.com)