



RGFD

Parts List
19-October-2016



*This parts list is current as of the above revision date.
See <http://www.rheempartslists.net/92-42800-RGFD.pdf> for the current revision.*

90% Gas Furnaces - Modulating

No.	Notes	MODEL HEATING CAPACITY BLOWER DESIGNATION VARIATIONS AIRFLOW FUEL DESIGNATION	RGFD	RGFD	RGFD	RGFD	RGFD	
			06E/06N M C K B/S	07E/07N M C K B/S	09E/09N Z C M B/S	10E/10N Z C M B/S	12E/12N R C M B/S	
ELECTRIC GROUP								
14		Door Switch - Push Button	42-22692-05	42-22692-05	42-22692-05	42-22692-05	42-22692-05	
15	Stk	Limit - Main Limit (Heat Exchanger Panel)	47-25350-01	47-25350-01	47-25350-07	47-25350-07	47-25350-01	
16	Stk	Limit - Manual Reset (Burner Compartment) - Before F2100	47-22861-01 (1)	47-22861-01 (1)	47-22861-01 (1)	47-22861-01 (2)	47-22861-01 (2)	
16	Stk	Limit - Manual Reset (Burner Compartment) - After F2100	47-22861-02 (1)	47-22861-02 (2)	47-22861-02 (2)	47-22861-02 (2)	47-22861-02 (3)	
16a		Bracket (Limit - Manual Reset)	See Heat Exchanger Group					
17	Stk	High Pressure Switch (Vent)	42-24387-05	42-24387-01	42-24387-05	42-24387-09	42-24387-03	
18	Stk	Low Pressure Switch (Drain)	42-24387-02	42-24387-02	42-24387-10	42-24387-02	42-24387-02	
19	Stk	Induced Draft Blower w/Gasket	70-24206-01	70-24206-01	70-24206-01	70-24206-01	70-24206-01	
20	Stk	Capacitor - Induced Draft Blower	43-25134-27	43-25134-27	43-25134-27	43-25134-27	43-25134-27	
21		Gasket - Induced Draft Blower	68-24016-01	68-24016-01	68-24016-01	68-24016-01	68-24016-01	
22	Stk	Transformer w/Fuse - Before F4798	46-22863-02	46-22863-02	46-22863-02	46-22863-02	46-22863-02	
22	Stk	Transformer w/Fuse - Date Codes F4798-F2205	46-22863-04	46-22863-04	46-22863-04	46-22863-04	46-22863-04	
22	Stk	Transformer - After F2205	46-24124-03	46-24124-03	46-24124-03	46-24124-03	46-24124-03	
		Transformer Fuse (9/16 in.)	46-22863-82	46-22863-82	46-22863-82	46-22863-82	46-22863-82	
		Transformer Fuse (1-1/4 in.)	44-MDL2-5PK	44-MDL2-5PK	44-MDL2-5PK	44-MDL2-5PK	44-MDL2-5PK	
23		Power Factor Choke	46-24256-02	46-24256-02	46-24256-02	46-24256-02	46-24256-02	
	Stk	Thermistor - Duct Mounted	47-24225-01	47-24225-01	47-24225-01	47-24225-01	47-24225-01	
29	Stk	Thermistor - Return Air Sensor	47-24253-01	47-24253-01	47-24253-01	47-24253-01	47-24253-01	
wh1		Wiring Harness - 3 pin to stripback, terminal and eye connectors (Before F4300)	AS-61998-21	AS-61998-21	AS-61998-21	AS-61998-21	AS-61998-21	
wh1		Wiring Harness - 3 pin to stripback, terminal and eye connectors (After F4300)	45-24371-42	45-24371-42	45-24371-42	45-24371-42	45-24371-42	
wh2		Wiring Harness - 15 pin to 9 pin, 6 pin and 4 pin connectors (Before F4300)	AS-61997-22	AS-61997-22	AS-61997-22	AS-61997-22	AS-61997-22	
wh2		Wiring Harness - 15 pin to 15 pin and two 4 pin connectors (After F4300)	45-24371-34	45-24371-34	45-24371-34	45-24371-34	45-24371-34	
wh3		Wiring Harness - 5 pin to 2 pin and 3 pin connectors (Before F4300)	AS-61997-23	AS-61997-23	AS-61997-23	AS-61997-23	AS-61997-23	
wh3		Wiring Harness - 5 pin to 2 pin and 3 pin connectors (After F4300)	45-24371-33	45-24371-33	45-24371-33	45-24371-33	45-24371-33	
wh4		Wiring Harness (ECM motor) - 16 pin to 5 pin	45-24258-07	45-24258-07	45-24258-07	45-24258-07	45-24258-07	
wh5		Wire Harness - 9 pin to 11 straight terminals and 6 pin to 2 pin, 3 pin and 4 pin (Before F4300)	45-24089-06	45-24089-06	45-24089-06	45-24089-06	45-24089-06	
wh5		Wire Harness - 15 pin to 3 pin, 2 pin and 11 straight terminals (Date Codes F4300-F1702)	45-24090-07	45-24090-07	45-24090-07	45-24090-07	45-24090-07	
wh5		Wire Harness - 15 pin to 3 pin, 2 pin and 11 straight terminals - w/Twist Lock (After F1702)	45-24393-05	45-24393-05	45-24393-05	45-24393-05	45-24393-05	

No.	Notes	MODEL HEATING CAPACITY BLOWER DESIGNATION VARIATIONS AIRFLOW FUEL DESIGNATION	RGFD	RGFD	RGFD	RGFD	RGFD	
			06E/06N M C K B/S	07E/07N M C K B/S	09E/09N Z C M B/S	10E/10N Z C M B/S	12E/12N R C M B/S	
BLOWER GROUP								
24	Stk	Blower Assembly (Includes items 25-29)	AS-61697-68	AS-61697-68	AS-61697-69	AS-61697-69	AS-61697-71	
25		Housing	AS-61674-13	AS-61674-13	AS-61674-23	AS-61674-23	AS-61674-12	
26	Stk	Blower Motor - ECM	51-24374-01	51-24374-01	51-24376-03	51-24376-03	51-24376-01	
		Motor Mount Kit (Grommets, Screws, Nuts, Belly Band, Brackets)	70-24104-82	70-24104-82	70-24104-82	70-24104-82	70-24104-82	
		ECM Motor Mount (Belly Band)	70-24104-02	70-24104-02	70-24104-02	70-24104-02	70-24104-02	
27		Motor Mount Bracket (4)	AE-61956-01	AE-61956-01	AE-61956-01	AE-61956-01	AE-61956-01	
28	Stk	Blower Wheel - Before F2101	70-24254-02	70-24254-02	70-23112-01	70-23112-01	70-24255-01	
28	Stk	Blower Wheel - After F2101	70-24254-02	70-24254-02	70-24179-01	70-24179-01	70-23111-20	
29		Thermistor - Return Air Sensor	See Electrical Group					

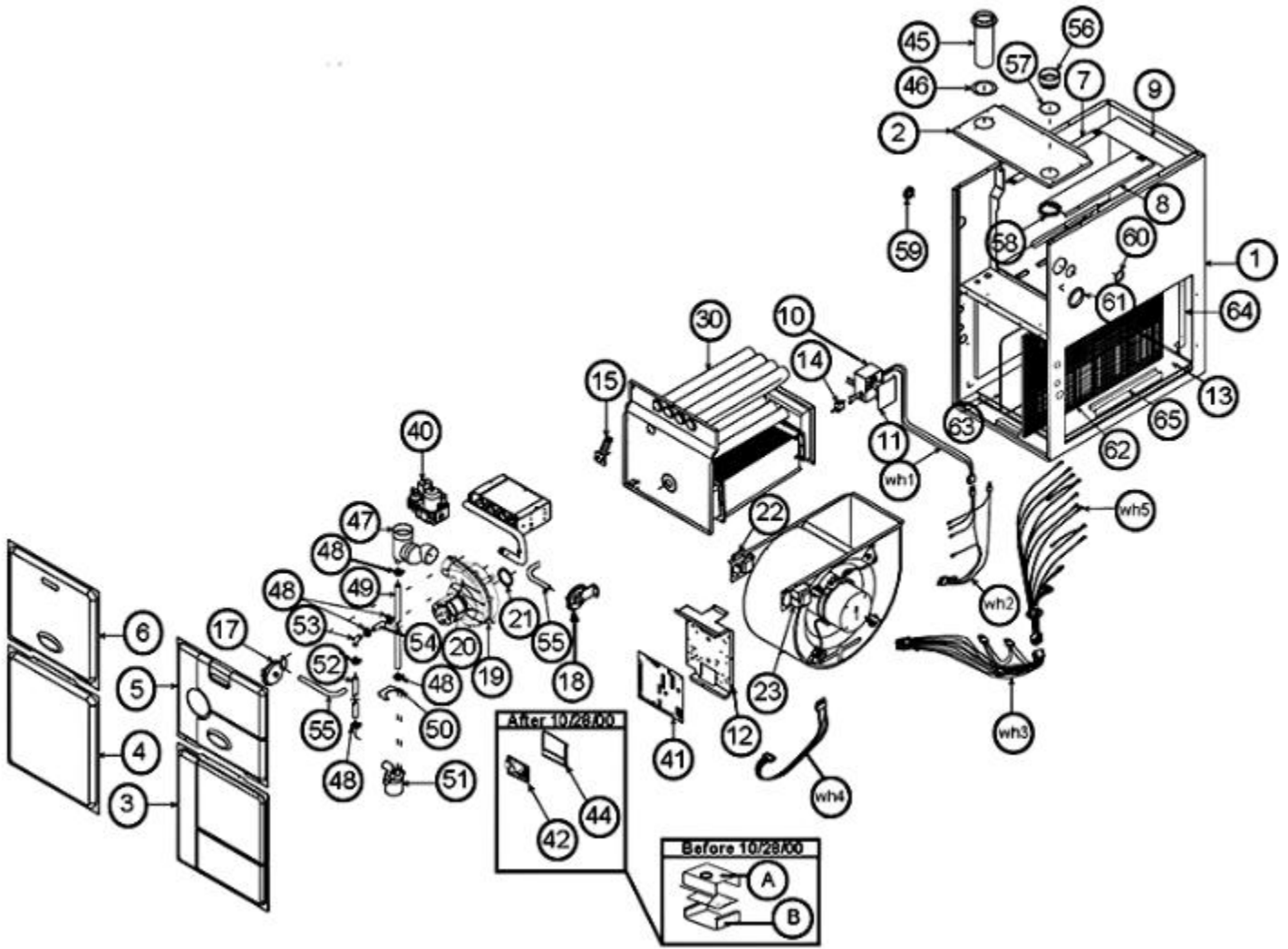

Exploded View