

Model# 0331-1/2
 0331-3/8
 0331-L1/2
 0331-L3/8
 0331-LV1/2
 0331-LV3/8
 0331-V1/2

La Vergne, TN 37086
 Fax: 800.338.9414
 Email: sales@centralbrass.com
 www.centralbrass.com

There is more than 1 version of this model. Page down to identify the version you have.

1st generation-manufactured before May 2013.

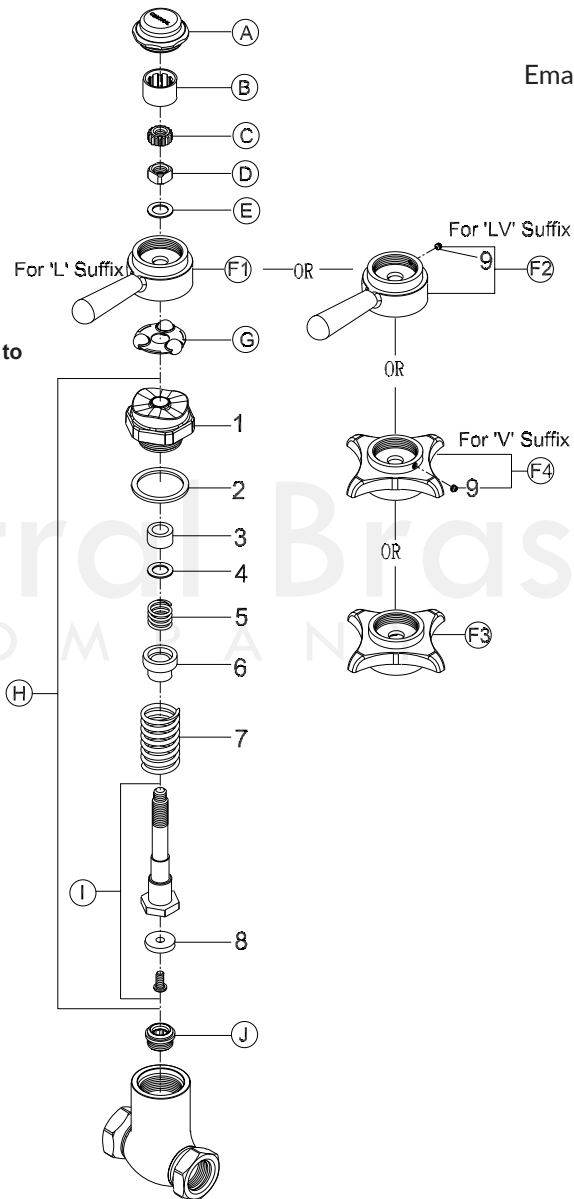

ITEM#	DESCRIPTION	ITEM#	DESCRIPTION
A	PF-7125,C,H	I	SU-7101-AF
B	X69-C	J	XPF-59
C	XPF-67-AC	1	7106-F
D	X68-HX	2	X433-AN
E	X33-A	3	X849-GN*
F1	PF-7114-P [For 'L' Suffix]	4	XPF-33-A*
F2	G-7114-V [For 'LV' Suffix]	5	X70-D*
F3	PF-6928-P	6	XPF-70-F*
F4	G-6928-V [For 'V' Suffix]	7	1008-B
G	X71	8	X904-N
H	G-7106-F	9	X103-HSSS

0331 Series/REV. 09 2016

Model# 0331-1/2
 0331-3/8
 0331-L1/2
 0331-L3/8
 0331-LV1/2
 0331-LV3/8
 0331-V1/2

La Vergne, TN 37086
 Fax: 800.338.9414
 Email: sales@centralbrass.com
 www.centralbrass.com

2nd generation-manufactured after May 2013.

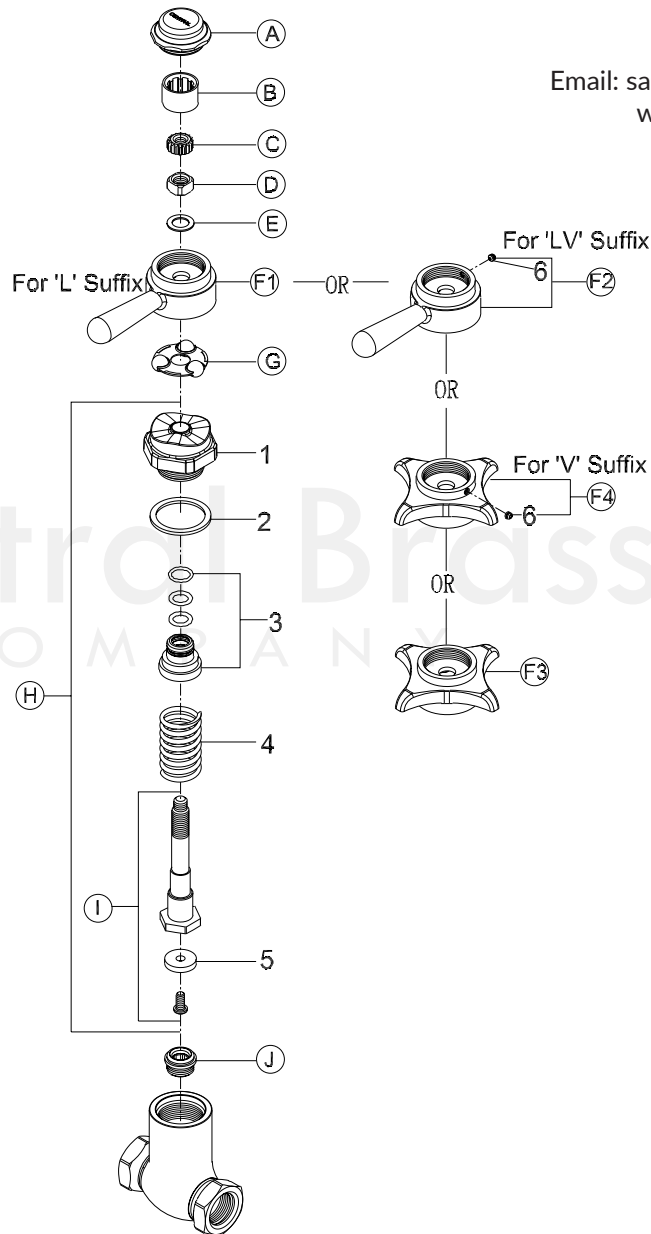

ITEM#	DESCRIPTION	ITEM#	DESCRIPTION
A	PF-7125,C,H	H	CS-39002
B	X69-C	I	SU-7101-AF
C	XPF-67-AC	J	XPF-59
D	X68-HX	1	7106-F
E	X33-A	2	X433-AN
F1	PF-7114-P [For 'L' Suffix]	3	CS-49026
F2	G-7114-V [For 'LV' Suffix]	4	1008-B
F3	PF-6928-P	5	X904-N
F4	G-6928-V [For 'V' Suffix]	6	X103-HSSS
G	X71		